



KE175-D2



Catálogo de Partes



KE175-D Series

Motorcycle Parts Catalog

KE175-D1

KE175-D2

PARTS LIST INTRODUCTION

This parts catalog lists parts and subassemblies provided as spare parts.

When it becomes necessary to replace parts, always use KAWASAKI GENUINE PARTS which passed strict inspection which guaranties quality and performance.

1. COMPOSITION OF THE PART NUMBER

1-1 Part Number (Old structure)

○○○○○ - ○○○ - ○○

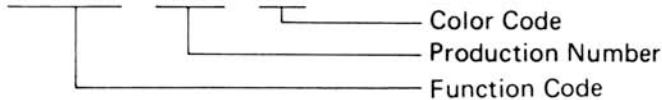

(New Structure)

○○○○○ - ○○○○ - ○○

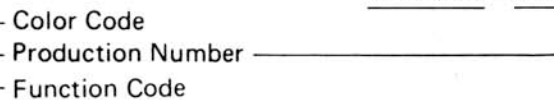

1-2 Standard Hardware Number

○○○ ○ ○○○○ A

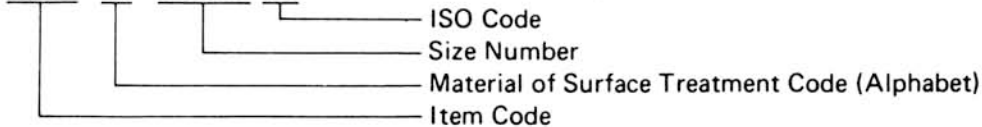

2. ABBREVIATIONS

- (1) WHEN EXH USE P/No. _____
Abbreviated from the phrase "When exhausted, use P/No. _____" which indicates that the new parts be used for replacement, but old parts in stock may be used until exhausted.
- (2) E/No. _____ and Below. E/NO. _____ and Above.
These are applied to the part requested to use only for engines having the serial number _____ and below (or above).
- (3) "AR" indicates the part is to be used "as required". It is used mainly for bulk items such as liquid gasket.
- (4) "ALT" indicates the part may be used as "alternate", if another part called for that location is not available.

(5) STD	Standard	T	Teeth	t	Thickness
ASSY	Assembly	PR	Ply Rating	I. D.	Inside Diameter
Ref.	Reference	Hex	Hexagonal	O. D.	Outside Diameter
L. H.	Left Hand	L	Length	AR	As Required
R. H.	Right Hand	d	Diameter	C. A.	Cut Away
ALT	Alternate	N. A.	Not Available	W	Width

3. HOW TO ORDER PARTS

Always without fail include three items exactly as listed in this Parts Catalog in your parts order.

(1) Type and Model of motorcycle.

(2) Color Code

Specify the color using color code and name without fail for ordering of painted parts.

Example: 51001-1026-8G TANK, fuel, Ebony

(3) Part Name

Part not shown disassembled in the illustrations of this Parts Catalog are not sold separately; only the complete units or next higher assemblies illustrated, are supplied as spare parts.

Please be advised to order the parts in typescript instead of hand-writing to avoid the mistake expected.

4. MODEL YEAR

Selection of exclusive parts for a particular model year will be shown in the remarks column. If the entire part number page is for a particular model year, that model year will be listed in the grid heading. All part numbers without the model year shown will be common parts for the model, regardless of year.

KAWASAKI HEAVY INDUSTRIES, LTD.

MOTORCYCLE DIVISION

1-1, Kawasaki-cho, Akashi, Hyogo Pref. Japan

Part No. 99910-1055-02 ©

KE175-D1

Right Side View



Left Side View



● Color	Fuel Tank	Firecracker Red Brilliant Blue
	Front Fender	Firecracker Red Brilliant Blue
● Engine No.		KE175DE000101 to Subsequent
● Frame No.		KE175D-000101 to Subsequent
● Owner's Manual No.		99922-1041-01
● A & P Manual No.		99939-1033-01
● Service Manual No.		99924-1020-01

KE175-D2

Right Side View



Left Side View



• Color	Fuel Tank	Firecracker Red Brilliant Blue
	Front Fender	Firecracker Red Brilliant Blue
• Engine No.		KE175DE000601 to Subsequent
• Frame No.		KE175D-000601 to Subsequent
• Owner's Manual No.		99922-1056-01
• A & P Manual No.		99939-1033-01
• Service Manual No.		99924-1020-02



KE175-D Series

INDEX

1. Cylinder Head, Cylinder..... 1

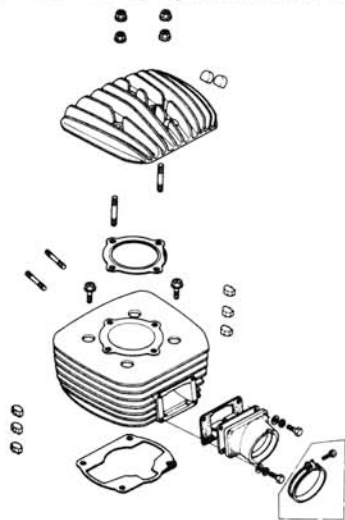

2. Crankcase 2

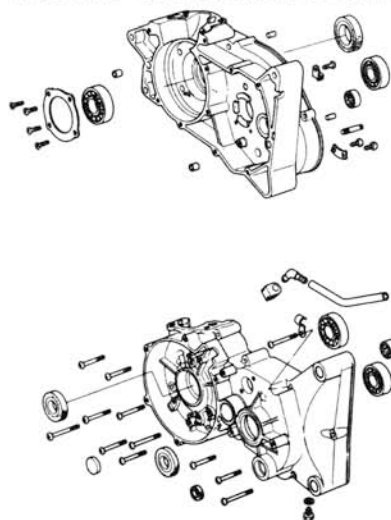

3. Piston, Crankshaft 3

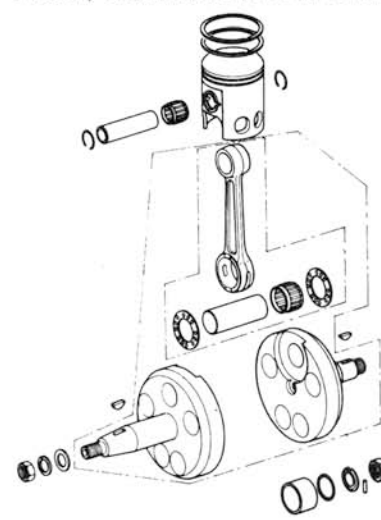

4. Clutch 4

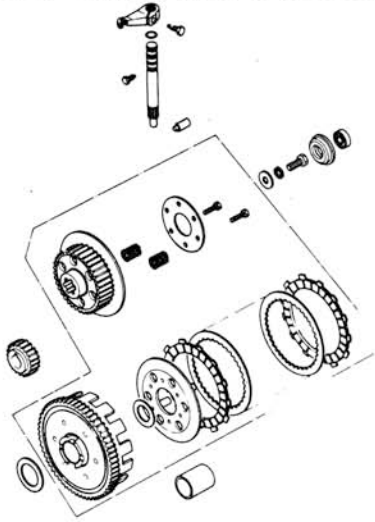

6. Change Drum, Shift Fork 6

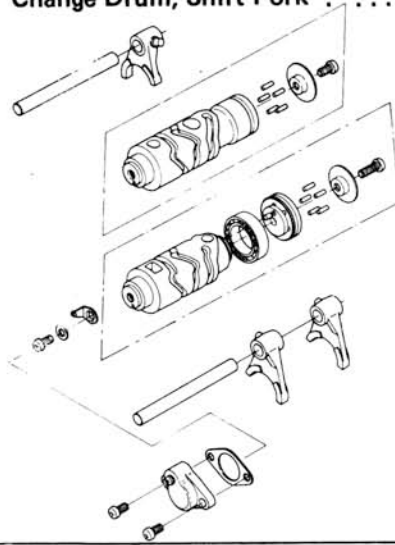

8. Kickstarter Mechanism..... 8

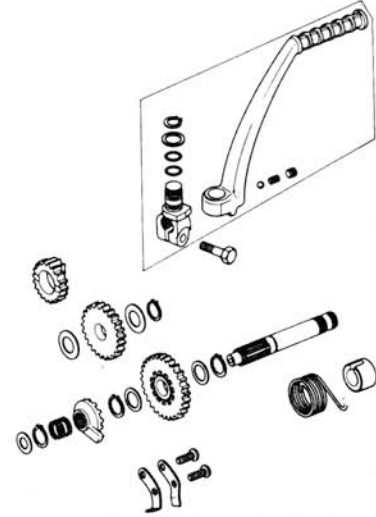

5. Transmission Gear 5

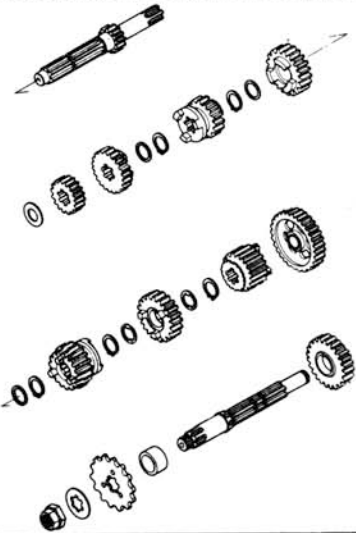

7. Gear Change Mechanism 7

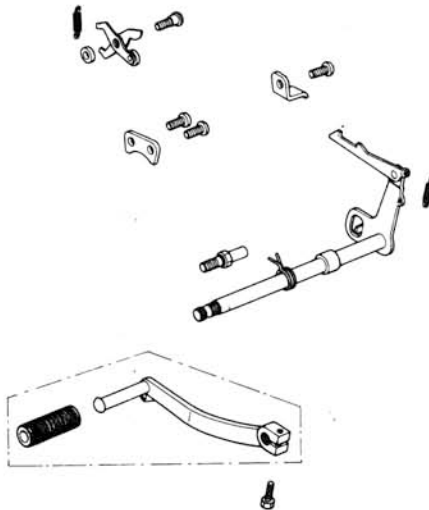

9. Engine Covers 9

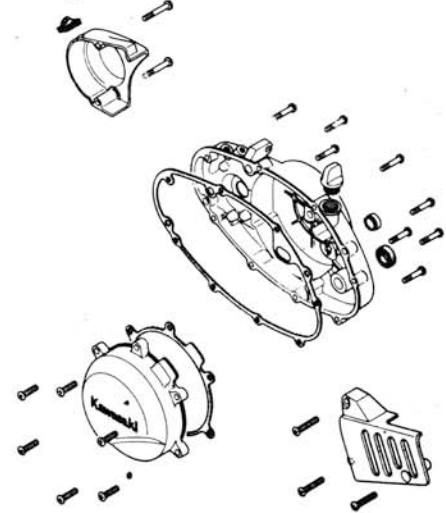

10. Carburetor 10

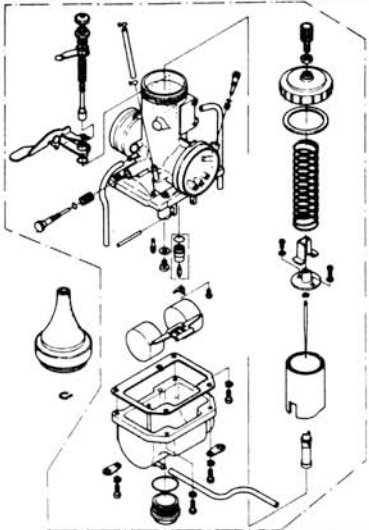

12. Air Cleaner 13

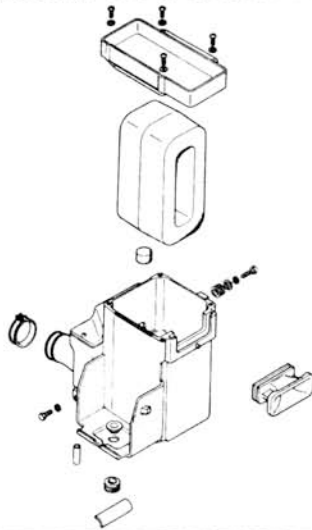

14. Electrical Equipment for Engine 15

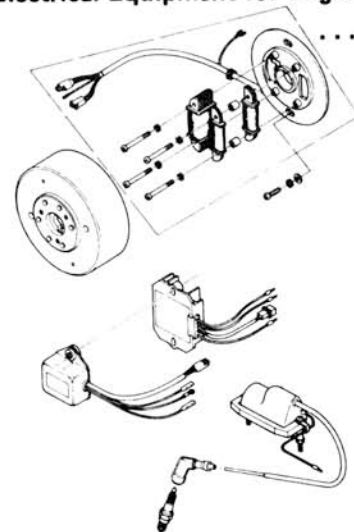

11. Oil Pump 12

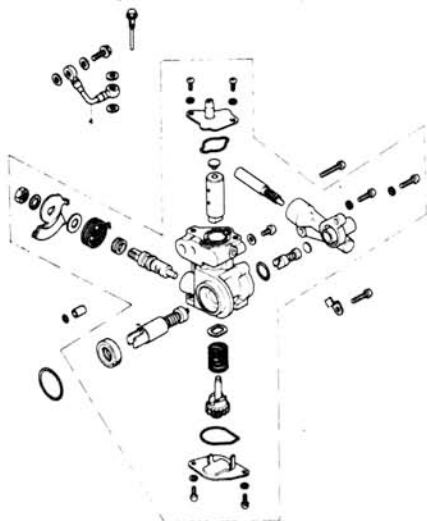

13. Muffler 14

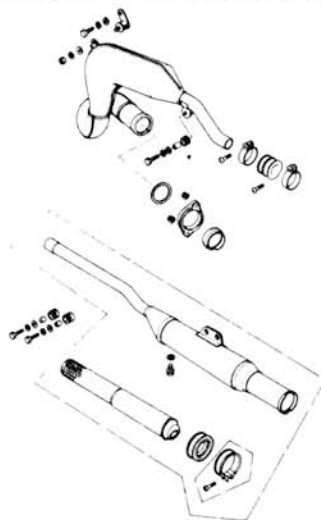

15. Frame 16

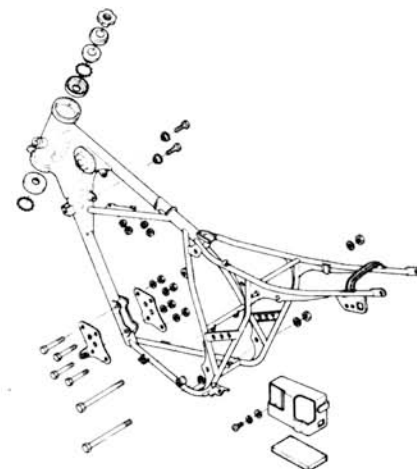

16. Swing Arm, Rear Shock Absorber

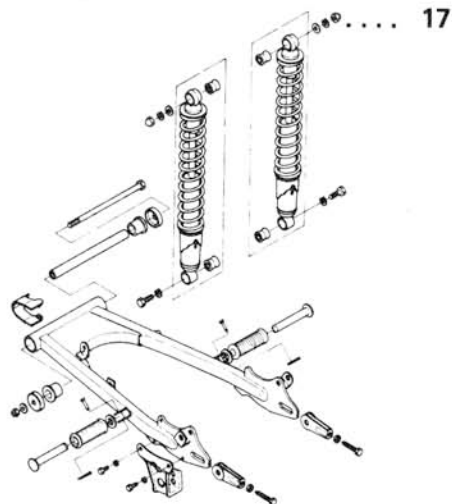

18. Brake Pedal, Torque Rod 19

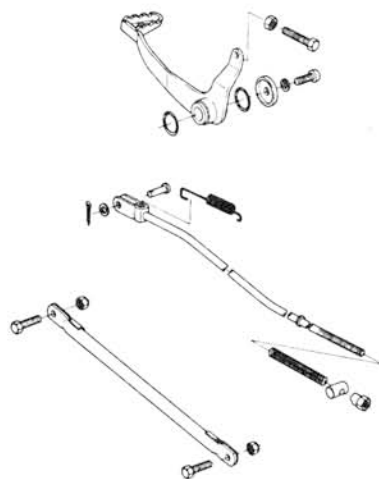

20. Front Fork 21

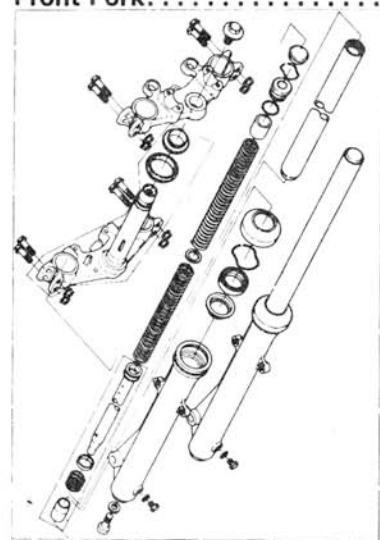

17. Footrests, stand 18

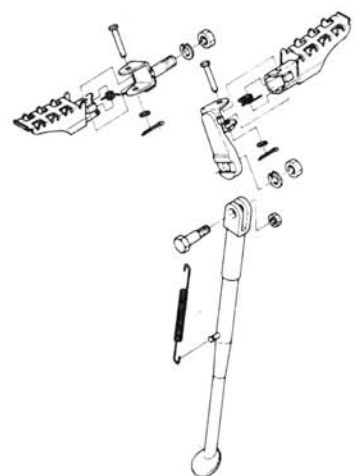

19. Handlebar, Grips 20

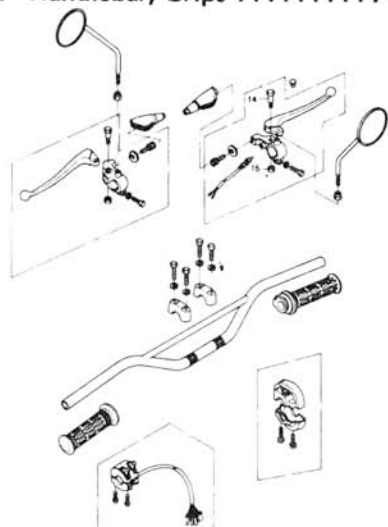

21. Fenders 22

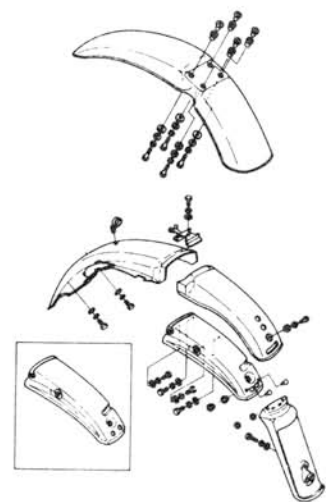

22. Wheels 24.

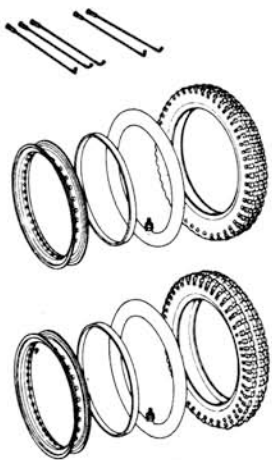

24. Rear Hub 26

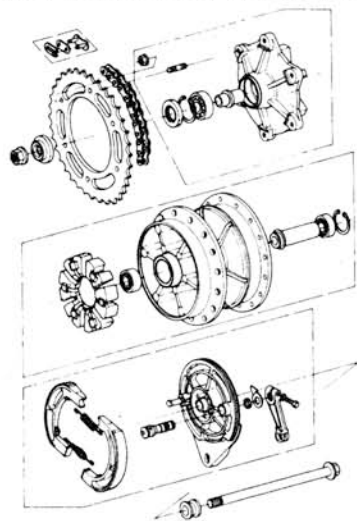

26. Oil Tank 29

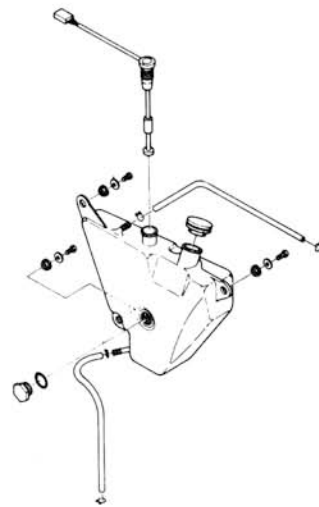

23. Front Hub 25

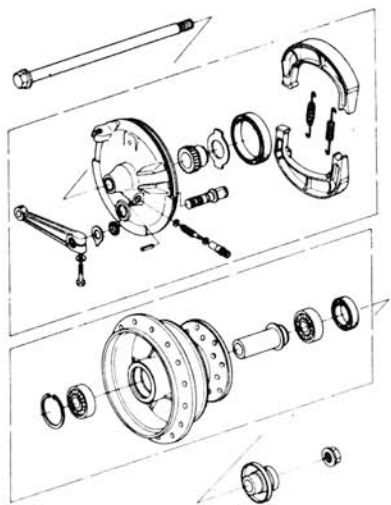

25. Fuel Tank 28

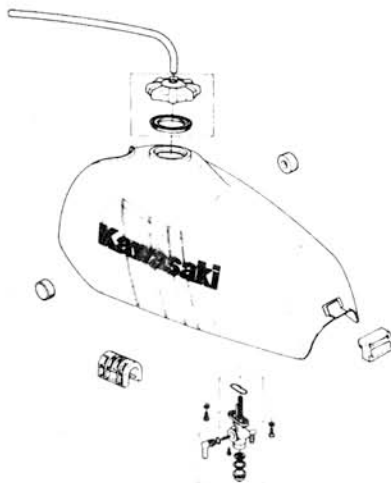

27. Side Covers, Chain Cover, Engine Guard 30

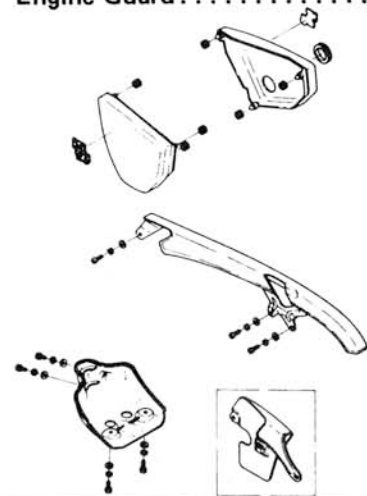

28. Dual Seat 31

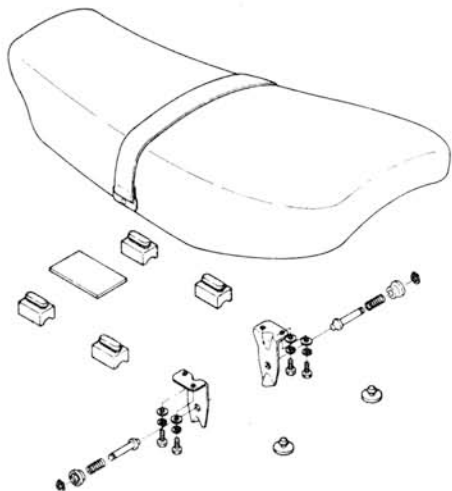

30. Speedometer 33

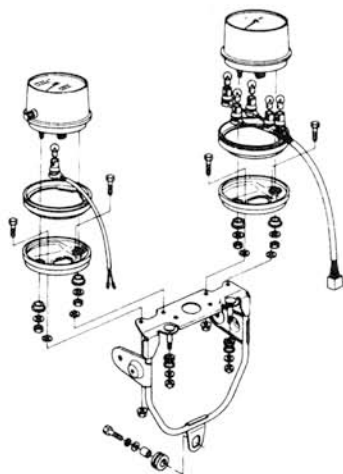

32. Tail Lamp 35

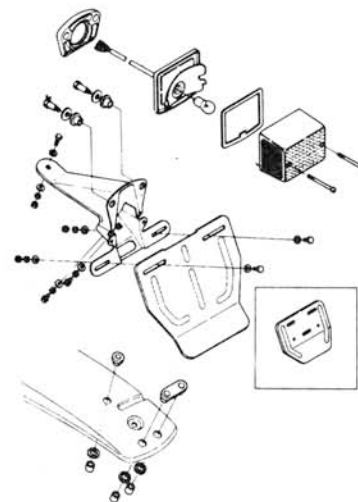

29. Cables 32



31. Head Lamp 34

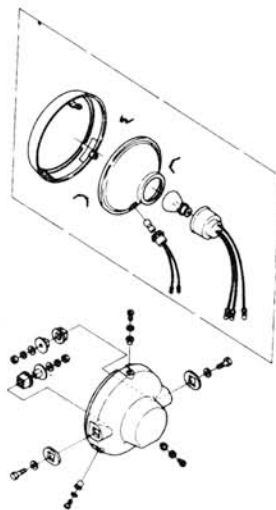

33. Turn Signal Lamps 36

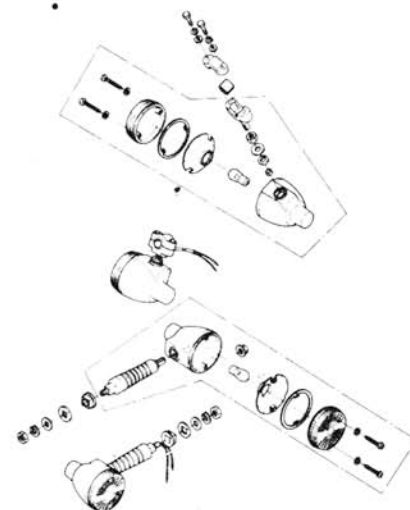

34. Ignition Switch, Reflector, Lock

... 37

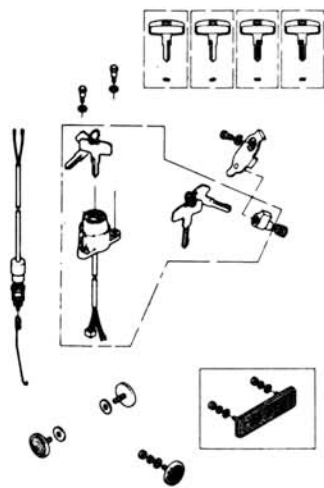

35. Electrical Equipments 38

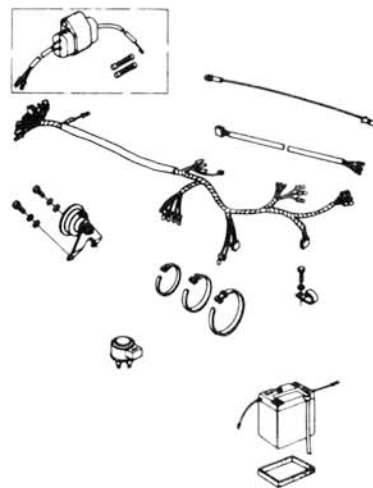

36. Tools 39

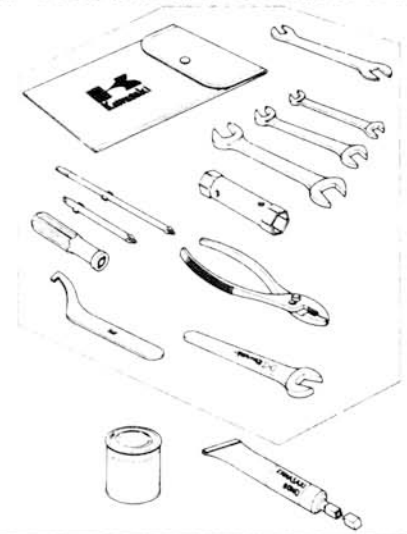

1. Cylinder Head, Cylinder

Rev. No.		Date	
----------	--	------	--

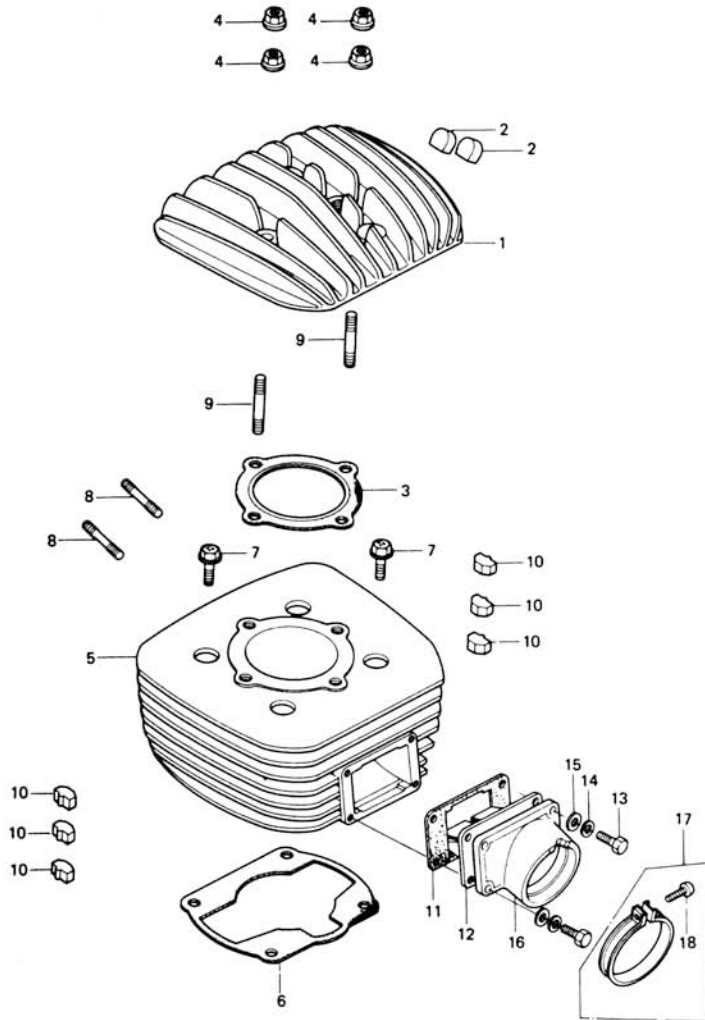

Ref. No.	Part No.	Part Name	Quantity	Remarks
1	11001-1047	HEAD, cylinder, Flat Brack	1	KE175 D2~
2	92075-1176	DAMPER RUBBER, cylinder head	12	KE175 D1
	92075-1176	DAMPER RUBBER, cylinder head	14	KE175 D2~
3	11004-1017	GASKET, cylinder head	1	
4	92015-1014	NUT	4	
5	11005-1084	CYLINDER, steel shot	1	KE175 D2 ~
6	11009-1060	GASKET, cylinder base	1	
7	131G0870	BOLT, flanged, 8 x 70	4	
8	92004-1008	STUD, 8 x 25	2	
9	92004-1009	STUD, 8 x 35	4	
10	92075-304	DAMPER RUBBER, cylinder	18	
11	11009-1109	GASKET, reed valve	1	
12	12021-1005	VALVE ASSY, reed	1	
13	110B0625	BOLT, hex head, 6 x 25	4	
14	461F0600	WASHER, spring, 6m/m	4	
15	411B0600	WASHER, plain, 6m/m	4	
16	16065-1025	HOLDER, carburetor	1	
17	92037-077	CLAMP, carburetor holder	1	
18	92011-037	SCREW, pan head, 5 x 25	1	

2. Crankcase

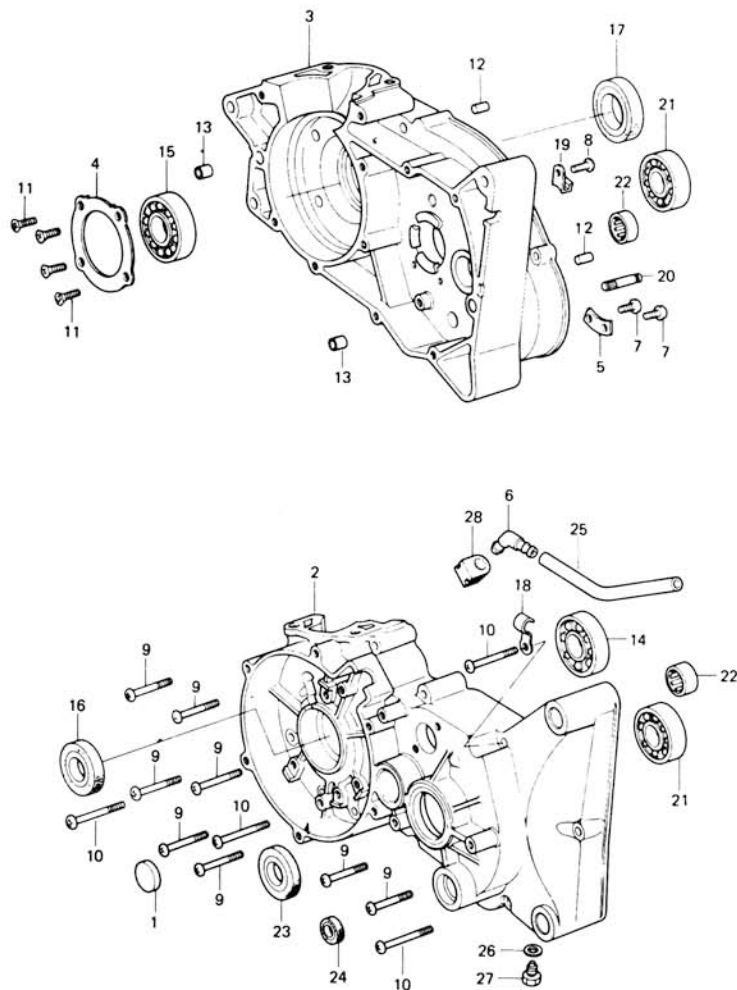

Rev. No.	Date

Ref. No.	Part No.	Part Name	Quantity		Remarks
			AUSTRALIA	GENERAL	
1	11012 1040	CAP, drive shaft sealed	1	1	
2	14002 1065	CRANKCASE, L.H, Aluminum Shot	1		
	14002 1023	CRANKCASE, L.H, Flat Black		1	
3	14002 1093	CRANKCASE, R.H, Aluminum Shot	1		
	14002 1024	CRANKCASE, R.H, Flat Black		1	KE175-D1
	14002 1079	CRANKCASE, R.H, Flat Black		1	KE175-D2~
4	14014 021	PLATE, position, crankshaft	1	1	
5	14014 022	PLATE, position, drive shaft	1	1	
6	14069 002	BREATHER, crankcase	1	1	
7	220B0612	SCREW, pan head, 6 x 12	2	2	
8	220B0614	SCREW, pan head, 6 x 14	1	1	
9	220B0640	SCREW, pan head, 6 x 40	8	8	
10	220B0660	SCREW, pan head, 6 x 60	4	4	
11	221B0616	SCREW, countersunk head, 6 x 16	4	4	
12	551A0816	Pin, dowel, 8 x 16	2	2	
13	552B1012	Pin, dowel, 10 x 12	2	2	
14	601B6205	BEARING, ball, #6205	1	1	
15	601B6305	BEARING, ball, #6305	1	1	
16	653B254007	OIL SEAL, TB25407	1	1	
17	653B324507	OIL SEAL, TB32457	1	1	
18	92037 016	CLAMP	1	1	
19	92037 157	CLAMP	1	1	
20	92043 117	PIN, kick spring	1	1	
21	92045 018	BEARING, ball, #6204N	2	2	
22	92046 026	BEARING, needle, #7E HKS 162412-1	2	2	
23	92050 039	OIL SEAL, #SC30426	1	1	
24	92051 005	OIL SEAL, #TB13225.5	1	1	
25	92059 061	TUBE, breather	1	1	
26	92065 058	GASKET	1	1	
27	92067 001	PLUG, oil drain	1	1	
28	92071-042	GROMMET, breather	1	1	

3. Piston, Crankshaft

Rev. No.		Date	
----------	--	------	--

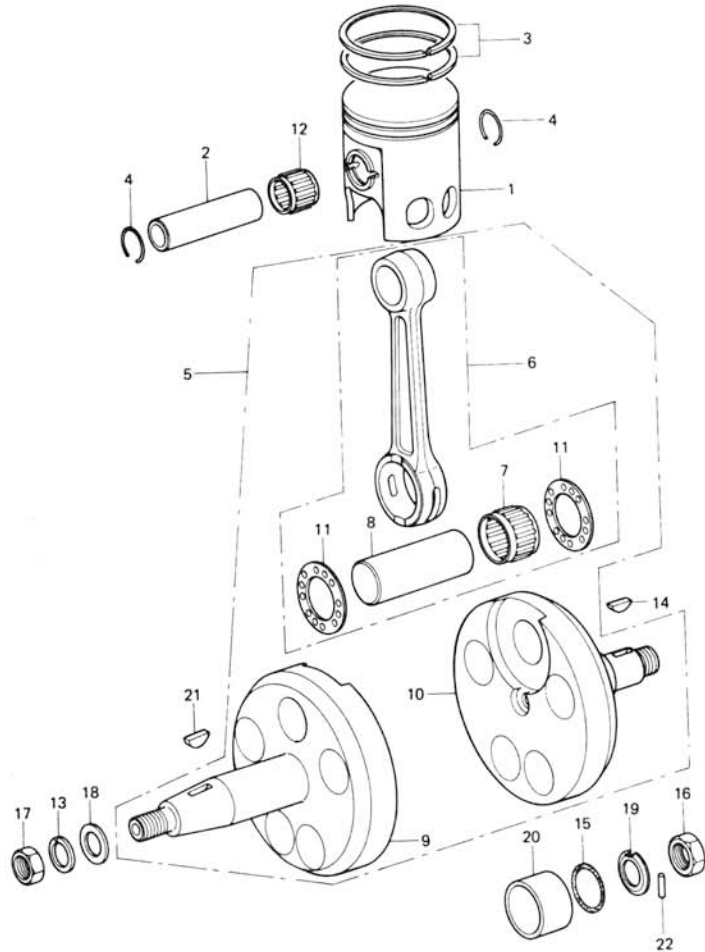

Ref. No.	Part No.	Part Name	Quantity	Remarks
1	13001-1041	PISTON, S.T.D.	1	
	13029-1015	PISTON, 0.020	1	
	13027-1016	PISTON, 0.040	1	
2	13002-1004	PIN, piston, 11 x 16 x 50.7	1	
3	13008-5021	RING SET, piston S.T.D.	1	
	13025-5017	RING SET, piston 0.020	1	
	13024-5017	RING SET, piston 0.040	1	
4	92036-004	CIRCLIP, piston pin	2	
5	13031-1011	CRANKSHAFT ASSY	1	
6	13044-5012	CONNECTING ROD ASSY	1	
7	13034-042	BEARING, needle, 22VS1925	1	
8	13035-022	PIN, crank	1	
9	13037-1012	CRANKSHAFT, L.H.	1	
10	13037-1013	CRANKSHAFT, R.H.	1	
11	92026-011	SPACER, side	2	
12	13033-016	BEARING, needle, KTV162022	1	
13	461E1400	WASHER, spring, 14 m/m	1	
14	510A4200	KEY, woodruff	1	
15	670B2020	"O" RING, 20 m/m	1	
16	92015-019	NUT, 18 m/m	1	
17	92015-043	NUT, 14 m/m	1	
18	92022-172	WASHER, plain, 14 m/m	1	
19	92024-077	WASHER, lock, 18 m/m	1	
20	92027-247	COLLAR, crankshaft	1	
21	92038-001	KEY, woodruff	1	
22	92042-051	PIN, dowel, 2.5 x 14.8	1	

4. Clutch

Rev. No.		Date	
----------	--	------	--

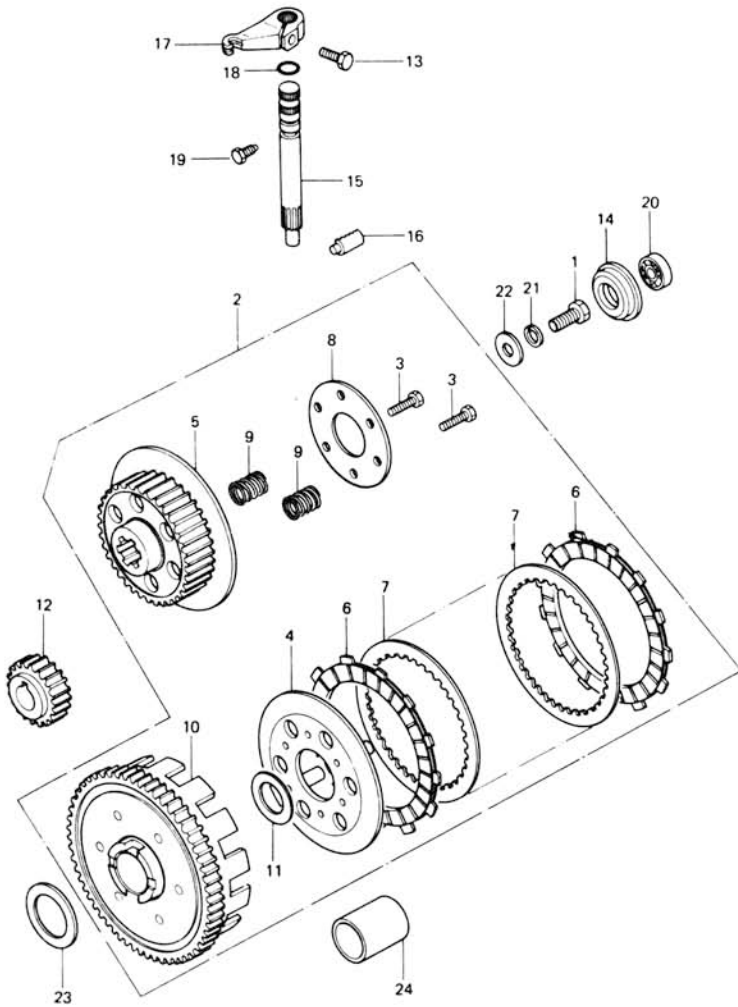

Ref. No.	Part No.	Part Name	Quantity	Remarks
1	113G1022	BOLT, hex head, 10 x 22	1	
2	13081 1031	CLUTCH ASSY	1	
3	110B0520A	BOLT, hex head, 5 x 20	6	
4	13086 017	WHEEL, clutch	1	
5	13087-041	HUB, clutch	1	
6	13088 025	PLATE, clutch friction	5	
7	13089 003	PLATE, clutch	4	
8	13091 1017	HOLDER, clutch spring	1	
9	92081 1174	SPRING, clutch	6	
10	13095 053	HOUSING, clutch	1	
11	92022-168	WASHER, clutch thrust	1	
12	13097-1006	GEAR, primary, 24T	1	
13	110G0618	BOLT, hex head, 6 x 18	1	
14	13091 1018	HOLDER, clutch pusher	1	
15	13106-1002	SHAFT, clutch release	1	
16	13114 1003	PUSHER, clutch	1	
17	13168-1023	LEVER, clutch release	1	
18	670B1509	"O" RING, 9m/m	1	
19	92003-130	BOLT, clutch release	1	
20	92045-1010	BEARING, ball, #626	1	
21	461E1000	WASHER, spring, 10m/m	1	
22	92022-1088	WASHER, 10.2 x 28 x 2	1	
23	92022-168	WASHER, clutch thrust	1	
24	92028 014	BUSHING, clutch	1	

5. Transmission Gear

Rev. No.	Date
----------	------

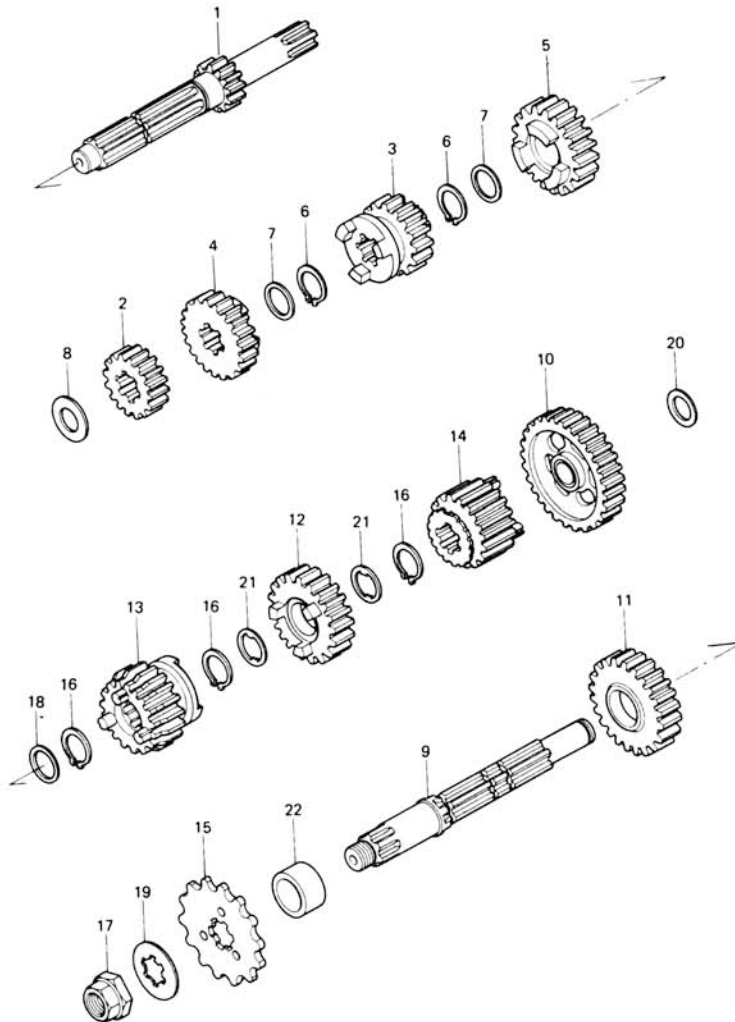

Ref. No.	Part No.	Part Name	Quantity	Remarks
1	13127-1006	SHAFT, drive, 12T	1	
2	13129-1075	2ND GEAR, drive shaft, 17T	1	
3	13129-1141	3RD GEAR, drive shaft, 18T	1	
4	13129-1143	4TH GEAR, drive shaft, 20T	1	
5	13129-1145	TOP GEAR, drive shaft, 25T	1	
6	480J2100	CIRCRIP, 21m/m	2	
7	92022-106	WASHER, 22.5 x 30 x 1.0	2	
8	92022-170	WASHER, 16.5 x 28 x 1.0	1	
9	13128-1008	SHAFT, output	1	
10	13129-051	LOW GEAR, driven shaft, 32T	1	
11	13129-1140	2ND GEAR, driven shaft, 28T	1	
12	13129-1142	3RD GEAR, driven shaft, 22T	1	
13	13129-1144	4TH GEAR, driven shaft, 19T	1	
14	13129-1134	TOP GEAR, driven shaft, 20T	1	
15	13144-066	ENGINE SPROCKET, 14T	1	
16	480J2100	CIRCRIP, 21m/m	3	
17	92015-1062	NUT, 14m/m	1	
18	92022-1087	WASHER, 22 x 28 x 2	1	
19	92022-1113	WASHER, splined, 1.0t	1	
20	92022-170	WASHER, 16.5 x 28 x 1.0	1	
21	92024-031	WASHER, lock	2	
22	92027-1083	COLLAR, 20 x 30 x 15	1	

6. Change Drum, Shift Fork

Rev. No.	Date

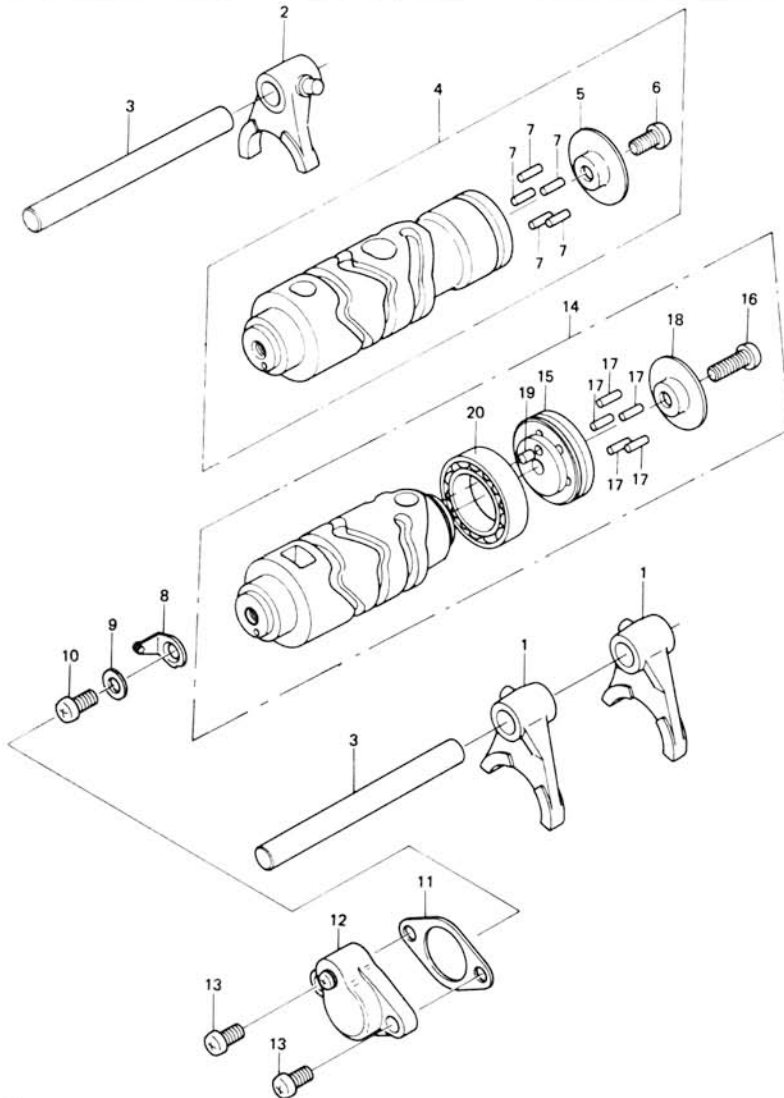

Ref. No.	Part No.	Part Name	Quantity	Remarks
1	13140 1013	FORK, shift, LOW, 2ND, 3RD	2	
2	13140 1014	FORK, shift, 4TH & STOP	1	
3	13209 015	ROD, shift	2	
4	13239 1013	DRUM ASSY, gear change	1	
5	13091 1016	HOLDER, change drum pin	1	
6	22080614	SCREW, pan head, 6 x 14	1	KE175-D1
7	92042 020	PIN, gear change drum	5	
8	21007 1003	ROTOR, neutral indicator switch	1	
9	41080600	WASHER, plain, 6m/m	1	
10	22080616	SCREW, pan head, 6 x 16	1	
11	13146 002	GASKET, neutral indicator switch	1	
12	13151 1001	SWITCH, neutral indicator	1	
13	22080616	SCREW, pan head, 6 x 16	2	
14	13239 1029	DRUM ASSY, gear change	1	
15	13091 1070	HOLDER, change drum pin	1	
16	22080630	SCREW, pan head, 6 x 30	1	KE175-D2~
17	92042 042	PIN, gear change drum	5	
18	13142 008	HOLDER, change drum pin	1	
19	610A0406	Pin, dowell, 4 x 6	1	
20	92045 036	BEARING, ball, #6905	1	

7. Gear Change Mechanism

Rev. No.	Date

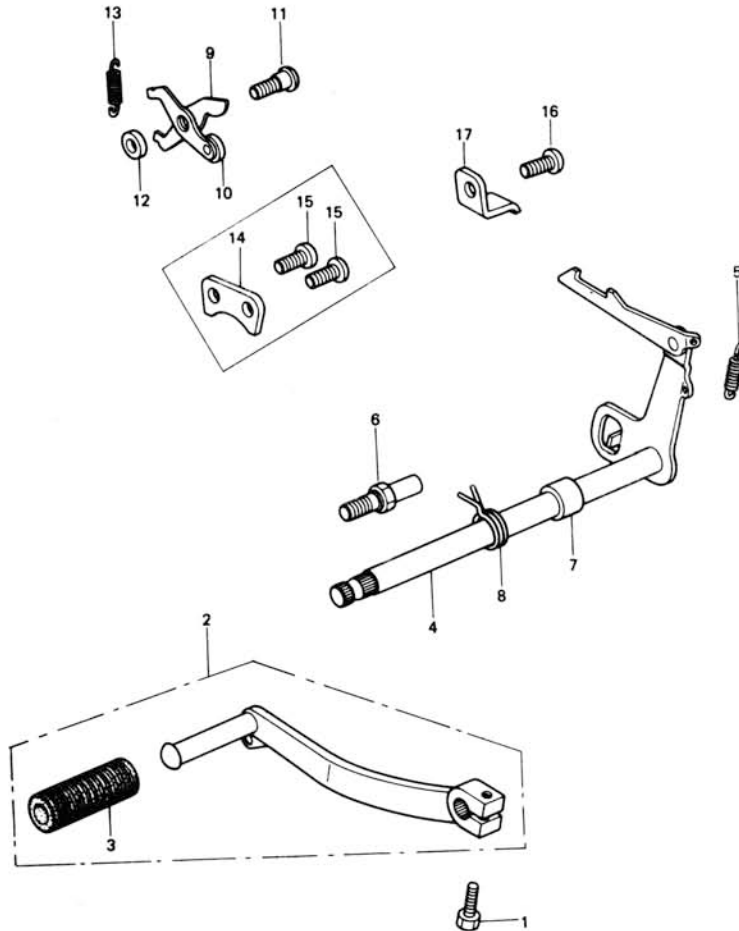

Ref. No.	Part No.	Part Name	Quantity	Remarks
1	110B0620	BOLT, hex head, 6 x 20	1	
2	13156-102C	PEDAL ASSY, gear change	1	
3	13157-004	DAMPER, gear change pedal	1	
4	13161-1006	LEVER ASSY, gear change	1	KE175-D1
	13161-1017	LEVER ASSY, gear change	1	KE175-D2~
5	92081-156	SPRING, change lever	1	
6	92001-1003	BOLT, return spring	1	
7	92027-189	COLLAR, 13 x 18 x 11.5	1	
8	92081-1129	SPRING, change pedal return	1	
9	13168-1047	LEVER, gear set	1	KE175-D1
	13168-1058	LEVER, gear set	1	KE175-D2~
10	13236-1004	LEVER, neutral	1	
11	92011-023	SCREW, change lever	1	
12	92026-1018	SPACER, 14 x 6 x 2.6	1	KE175-D1
13	92081-1237	SPRING, change lever	1	
14	13169-002	PLATE, change drum position	1	
15	220B0614	SCREW, pan head, 6 x 14	2	KE175-D1
16	220B0612	SCREW, pan head, 6 x 12	1	KE175-D2~
17	13169-1201	PLATE, change drum position	1	

8. Kickstarter Mechanism

Rev. No.	Date
----------	------

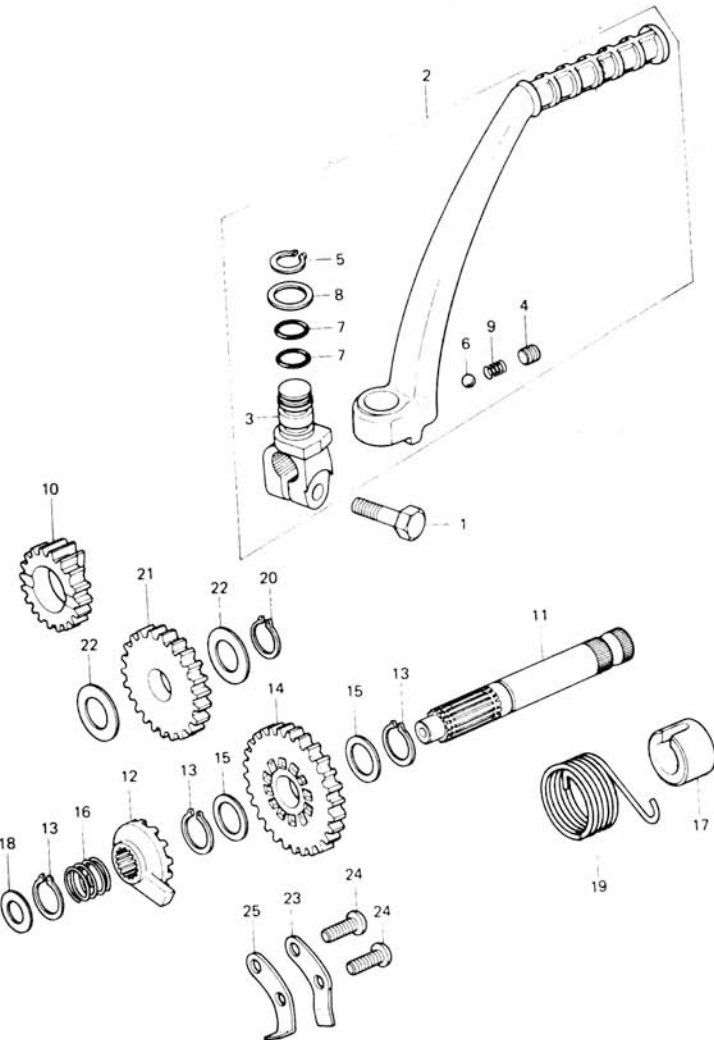

Ref. No.	Part No.	Part Name	Quantity	Remarks
1	114G0825	BOLT, hex head, 8 x 25	1	
2	13064 1009	PEDAL ASSY, kick	1	
3	13061 1023	BOSS, kick pedal	1	
4	290O0808	SCREW, socket, 8 x 8	1	
5	482K0100	CIRCLIP, 10 m/m	1	
6	600A0800	BALL, steel, 1/4"	1	
7	670B2012	"O" RING, 12 m/m	2	
8	92022-1019	WASHER, plain, 15.2 x 20 x 1.0	1	
9	92081 020	SPRING, kick pedal	1	
10	13075 006	GEAR, kick pinion, 20T	1	
11	13066 1006	SHAFT, kick	1	
12	13078 1001	RATCHET	1	
13	480J1600	CIRCLIP, 16 m/m	3	
14	59051-1010	GEAR, kickstarter, 34T	1	
15	92022 315	WASHER, plain, 16.8 x 22 x 0.5	2	
16	92081 122	SPRING, kick shaft	1	
17	13070 1007	GUIDE, kick spring	1	
18	92022 269	WASHER, plain, 12.3 x 20 x 0.5	1	
19	92082 005	SPRING, kick	1	
20	480J1500	CIRCLIP, 15 m/m	1	
21	59051-1019	GEAR, idle, 29T	1	
22	92022 169	WASHER, plain, 16.5 x 28 x 0.5	2	
23	13206 1002	GUID, kick	1	
24	220B0616	SCREW, pan head, 6 x 16	2	
25	32085-1027	STOPPER, kick	1	

9. Engine Covers

Rev. No.	Date

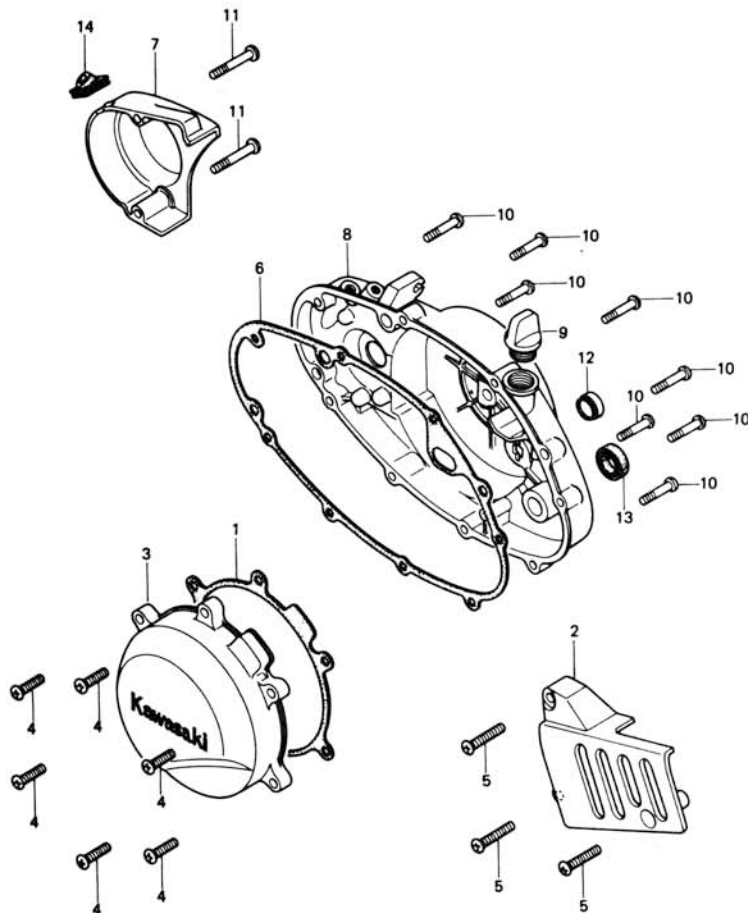

Ref. No.	Part No.	Part Name	Quantity	Remarks
1	11009-1063	GASKET, magneto cover	1	
2	14026-1016	COVER, chain, Flat Black	1	
3	14031-1016	COVER, magneto, Black	1	
4	220B0625	SCREW, pan head, 6 x 25	6	
5	220B0635	SCREW, pan head, 6 x 35	3	
6	11009-1062	GASKET, clutch cover	1	
7	14030-1009	COVER, oil pump, Flat Black	1	
8	14032-1007	COVER, clutch	1	
9	16115-018	CAP, oil filler	1	
10	220B0630	SCREW, pan head, 6 x 30	8	
11	220B0640	SCREW, pan head, 6 x 40	2	
12	52005-1005	GAUGE, oil level	1	
13	92051-003	OIL SEAL; TB16267	1	
14	92071-097	GROMMET	1	

10. Carburetor (1 / 2)

Rev. No.		Date	
----------	--	------	--

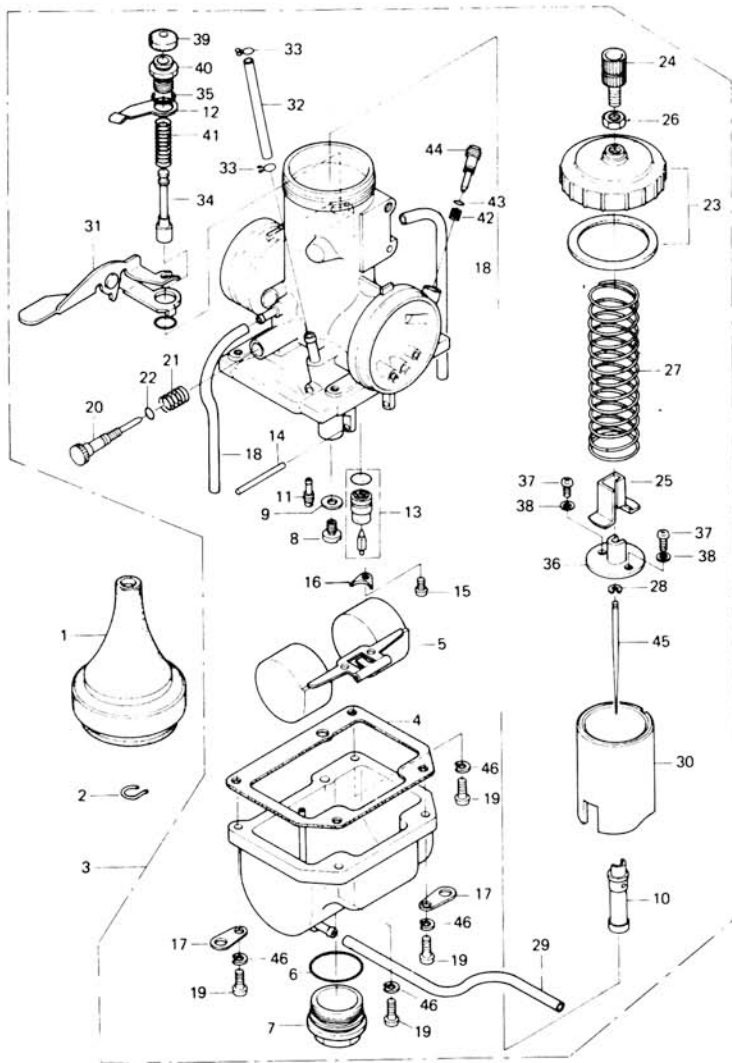

Ref. No.	Part No.	Part Name	Quantity		Remarks
			AUSTRALIA	GENERAL	
1	49006 1031	BOOT, cable adjuster	1	1	
2	92036 018	CIRCLIP	1	1	
3	16001 1155	CARBURETOR ASSY		1	KE175 D1
	16001-1184	CARBURETOR ASSY		1	KE175 D2~
		CARBURETOR ASSY		1	
4	11009 1178	GASKET, float chamber	1	1	
5	16031 1011	FLOAT	1	1	
6	92055 1076	"O" RING	1	1	
7	14025 1198	COVER, float chamber bottom	1	1	
8	92063 072	MAIN JET, #105R, STD		1	KE175 D1
	92063 071	MAIN HET, #102.5R, STD		1	KE175 D2~
	92063 063	MAIN JET, #97.5R	(1)	(1)	Option
	92063 070	MAIN JET, #100R	(1)	(1)	
	92063 073	MAIN JET, #107.5R	(1)	(1)	
	92063 074	MAIN JET, #110R	(1)	(1)	
	16034 001	WASHER, main jet	1	1	
9	16017-1072	NEEDLE JET, P-O		1	KE175 D2~
11	92064 032	PILOT JET, #25		1	
	92064 042	PILOT JET, #22.5		1	
12	13169 1224	SPRING PLATE, starter plunger	1	1	
13	16030 1011	FLOAT VALVE ASSY	1	1	
14	16032 003	PIN, float	1	1	
15	220B0408A	SCREW, pan head, 4 x 8	1	1	
16	13169 1190	PLATE, float valve	1	1	
17	13169 1226	PLATE, tube clamp	2	2	
18	92059 1116	TUBE, 3 x 5 x 100	2	2	
19	220B0416A	SCREW, pan head, 4 x 16	4	4	
20	16021 1012	SCREW, throttle adjust	1	1	
21	92081 1152	SPRING, throttle adjust screw	1	1	
22	92055 044	"O" RING	1	1	
23	16004 018	CAP, mixing chamber	1	1	
24	16002 014	ADJUSTER, cable	1	1	

10. Carburetor (2 / 2)

Rev. No.		Date	
----------	--	------	--

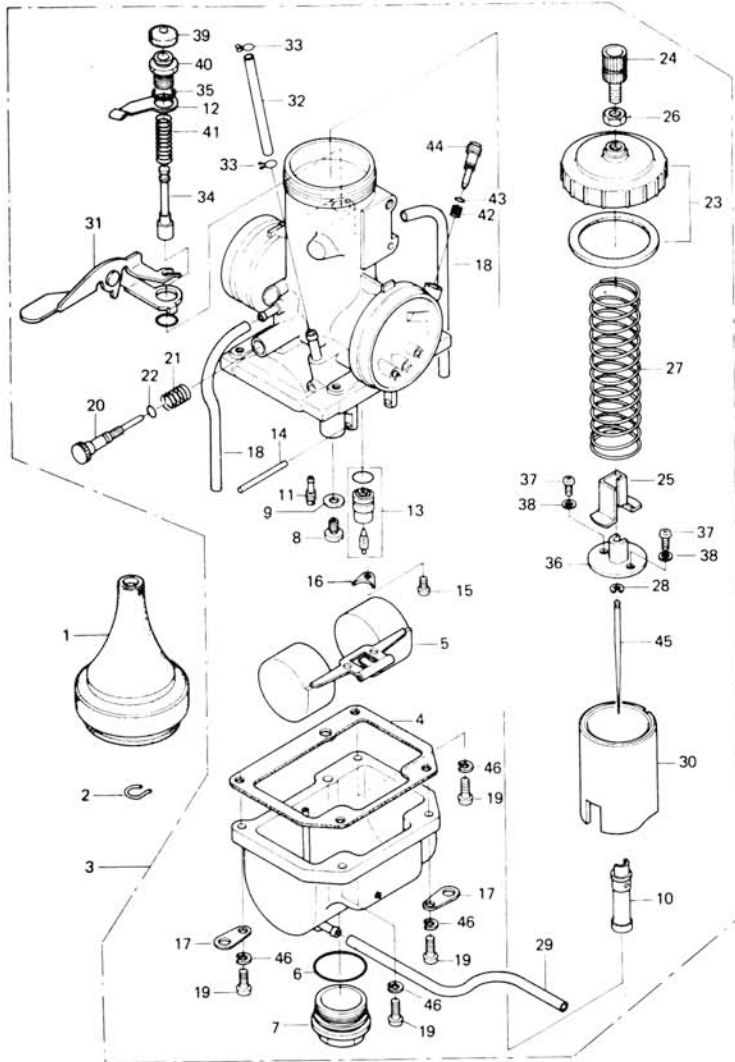

Ref. No.	Part No.	Part Name	Quantity	Remarks
25	14025 1197	COVER, throttle valve	1	
26	16003 006	NUT, cable adjust lock	1	
27	16006 023	SPRING, throttle valve	1	
28	16008 010	CIRCLIP, jet needle	1	
29	92059 1018	TUBE, 3 x 5 x 300	1	
30	16025 1039	VALVE, throttle, CA2.5	1	
31	16063 004	LEVER, starter plunger	1	
32	92059 130	TUBE, 5.3 x 10.5 x 210	1	
33	92037 072	CLAMP, fuel tube	2	
34	16016 1011	PLUNGER, starter	1	
35	670B1509	"O" RING	1	
36	13159 1004	CONNECTOR, throttle valve	1	
37	220B0310A	SCREW, pan head, 3 x 10	2	
38	461F0300	WASHER, spring, 3 m/m	2	
39	16039 015	CAP, starter plunger rubber	1	
40	16012 019	GUIDE HOLDER, starter plunger	1	
41	92081 1181	SPRING, starter plunger	1	
42	92081 1153	SPRING, air screw	1	
43	16038 022	"O" RING	1	
44	16014 1013	SCREW, air adjusting	1	
45	16009 1049	JET NEEDLE, 5CJ27 2	1	
46	461F0400	WASHER, spring, 4 m/m	4	

11. Oil Pump

Rev. No.	Date
----------	------

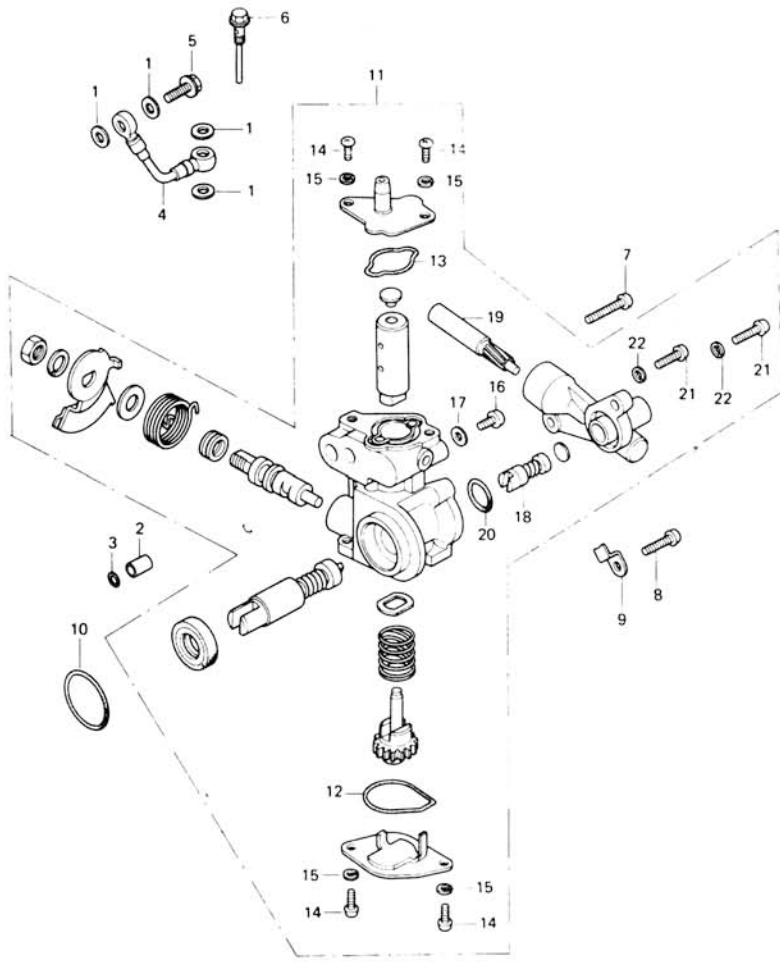

Ref. No.	Part No.	Part Name	Quantity	Remarks
1	92022 077	WASHER, plain, 6 m/m	4	
2	92027 256	COLLAR, 2.5 x 5 x 9.8	1	
3	92055 087	"O" RING, collar	1	
4	92059 1090	PIPE, oil	1	
5	92060 013	BOLT, banjo, 6 m/m	1	
6	92062 1008	NOZZLE	1	
7	220B0520A	SCREW, pan head, 5 x 20	1	
8	220B0616	SCREW, pan head, 6 x 16	1	
9	92037 1080	CLAMP	1	
10	92055 092	"O" RING	1	
11	16082 1012	OIL PUMP ASSY	1	
12	92055 1015	"O" RING, oil pump lower cap	1	
13	92055 1016	"O" RING, oil pump upper cap	1	
14	220B0308A	SCREW, pan head, 3 x 8	4	
15	461F0300	WASHER, spring, 3 m/m	4	
16	220B0508A	SCREW, pan head, 5 x 8	1	
17	92022 1025	WASHER, air vent	1	
18	41060 1007	GEAR, worm, tachometer	1	
19	41060 1008	GEAR, tachometer	1	
20	92055 1017	"O" RING, tachometer case	1	
21	220B0410A	SCREW, pan head, 4 x 10	2	
22	461F0400	WASHER, spring, 4 m/m	2	

12. Air Cleaner

Rev. No.	Date
----------	------

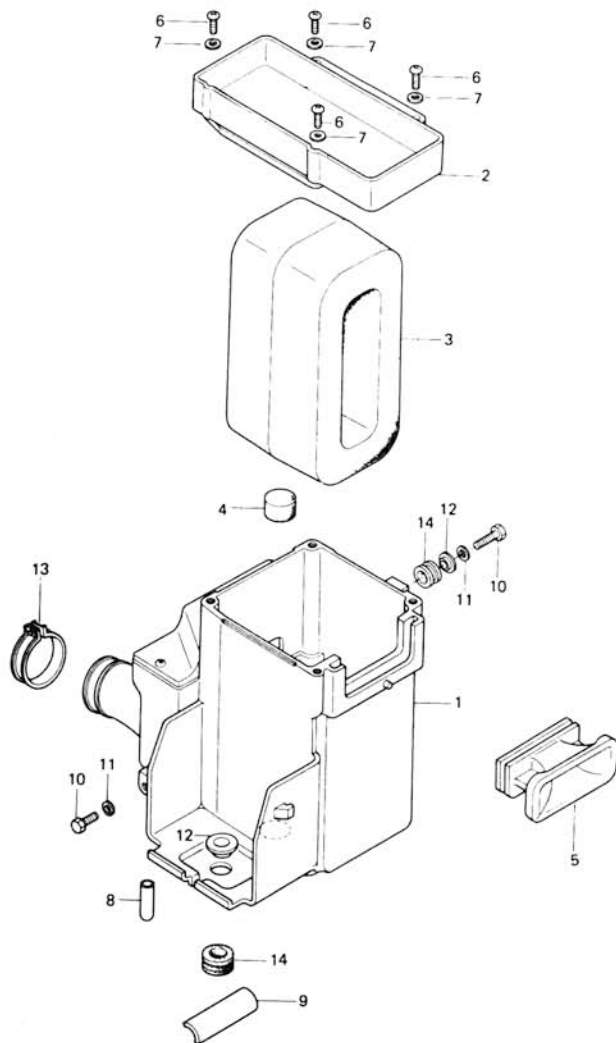

Ref. No.	Part No.	Part Name	Quantity	Remarks
1	11011-1039	CASE, air cleaner	1	
2	11012-1034	CAP, air cleaner	1	
3	11013-042	ELEMENT, air cleaner, WHN EXH USE	1	KE175 D1
	11013-1033	ELEMENT, air cleaner	1	KE175 D2~
4	11013-1019	ELEMENT, air cleaner	1	
5	14073-1029	DUCT, air cleaner inlet	1	
6	220B0414A	SCREW, pan head, 4 x 14	4	
7	410B0400	WASHER, plain	4	
8	92066-1014	PLUG, air cleaner drain	1	
9	92075-1085	DAMPER, air cleaner	1	
10	110B0620	BOLT, hex head, 6 x 20	2	
11	461F0600	WASHER, spring, 6 m/m	2	
12	92027-153	COLLAR,	2	
13	92037-061	CLAMP, air cleaner	1	
14	92075-051	DAMPER, air cleaner	2	

13. Muffler

Rev. No.		Date	
----------	--	------	--

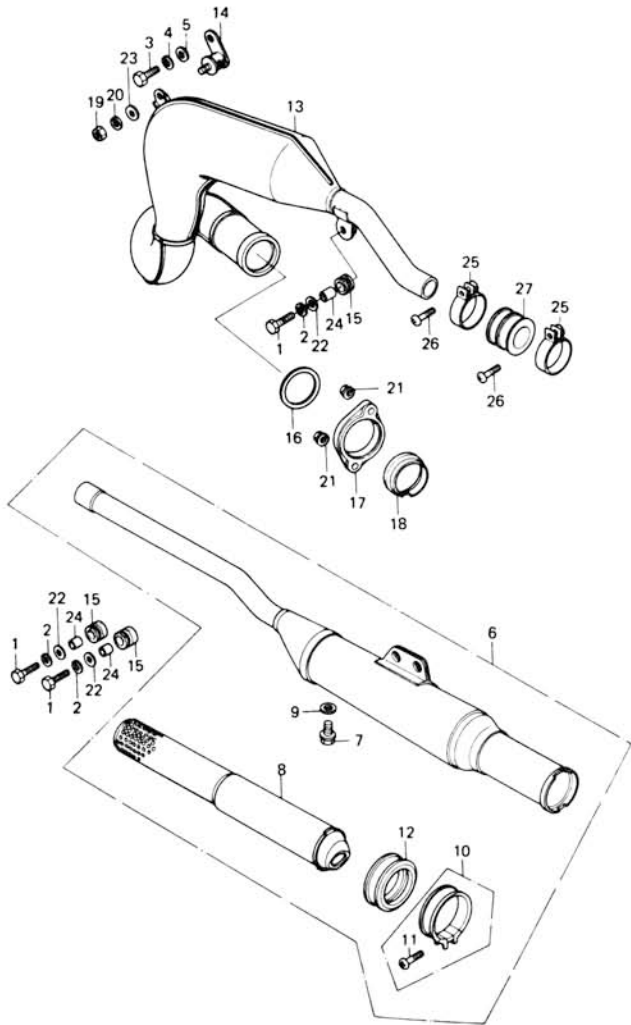

Ref. No.	Part No.	Part Name	Quantity	Remarks
1	110B0828	BOLT, hex head, 8 x 28	3	
2	461F0800	WASHER, spring, 8 m/m	3	
3	114B0816	BOLT, hex head, 8 x 28	1	
4	461F0800	WASHER, spring, 8 m/m	1	
5	410B0800	WASHER, plain, 8 m/m	1	
6	18001 1043	MUFFLER ASSY	1	
7	110B0608	BOLT, hex head	1	
8	49099 1006	BAFFLE PIPE, muffler	1	
9	92022 077	WASHER, 6.1 x 12 x 1	1	
10	92037 171	CLAMP, muffler	1	
11	220B0535A	SCREW, pan, head, 5 x 35	1	
12	92093 1013	SEAL, baffle pipe	1	
13	18006-1027	BODY, muffler	1	KE175 D2~
14	18061 060	BRACKET, muffler	1	
15	18063 005	DAMPER FUBBER, muffler	3	
16	18067 008	GASKET, exhaust pipe	1	
17	18069 049	HOLDER, exhaust pipe	1	
18	18070 007	COLLAR, exhaust pipe	1	
19	311B0800	NUT, 8 m/m	1	
20	461F0800	WASHER, spring, 8 m/m	1	
21	92017 013	NUT, lock, 8 m/m	2	
22	92022 035	WASHER, plain, 8 x 26 x 2.3	3	
23	92022 195	WASHER, plain, 8.5 x 20 x 1.6	1	
24	92027 102	COLLAR, 8.8 x 12 x 10.7	3	
25	92037 137	CLAMP, muffler connecting	2	
26	92011 033	SCREW, pan head, 6 x 35	2	
27	92093 1012	SEAL, muffler connecting	1	

14. Electrical Equipment for Engine

Rev. No.		Date	
----------	--	------	--

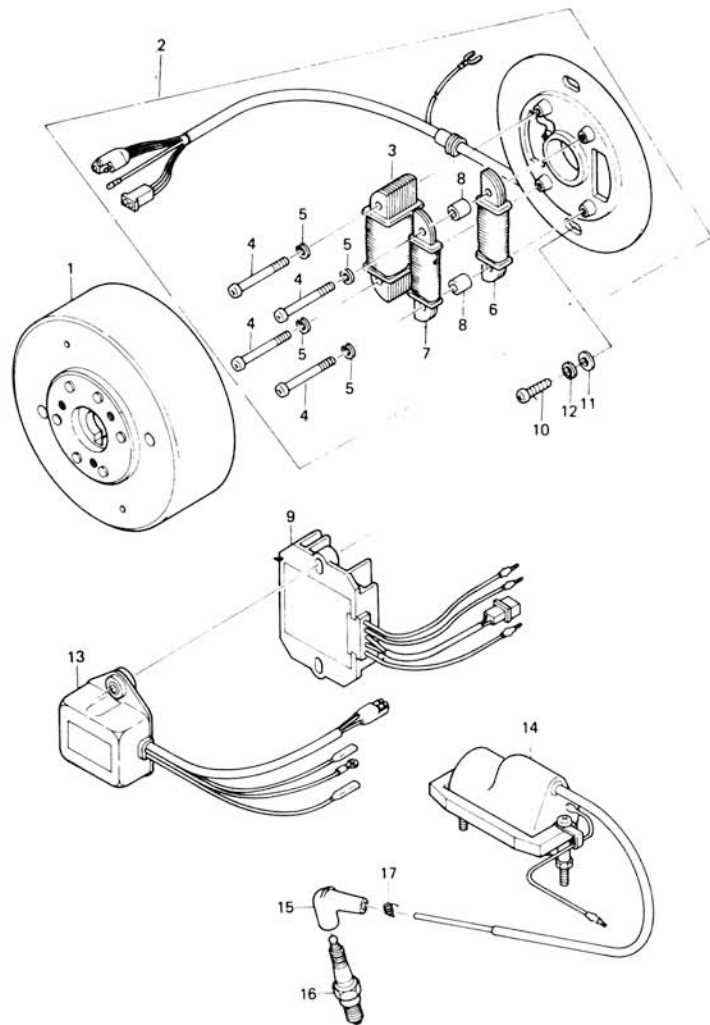

Ref. No.	Part No.	Part Name	Quantity	Remarks
1	21050-1013	FLYWHEEL, magneto	1	
2	21003-1023	STATOR ASSY, magneto	1	
3	59031-1003	COIL, changing	1	
4	220B0540A	SCREW, pan head, 5 x 40	4	
5	461F0500	WASHER, spring, 5 m/m	4	
6	21049-1006	COIL, exiting	1	
7	59026-1008	COIL, pulsing	1	
8	92027-1221	COLLAR, coil	2	
9	21066-1012	REGULATOR, voltage	1	
10	220B0620	SCREW, pan head, 6 x 20	2	
11	410B0600	WASHER, plain, 6 m/m	2	
12	461E0600	WASHER, spring, 6 m/m	2	
13	21119-1003	IGNITER	1	
14	21121-1012	COIL, ignition	1	
15	21130-009	CAP, spark plug	1	
16	92101-001	TERMINAL, spark plug cap	1	
17	92070-054	SPARK PLUG, NGK B9ES	1	

KE175-D2

15. Frame

Rev. No.	Date
----------	------

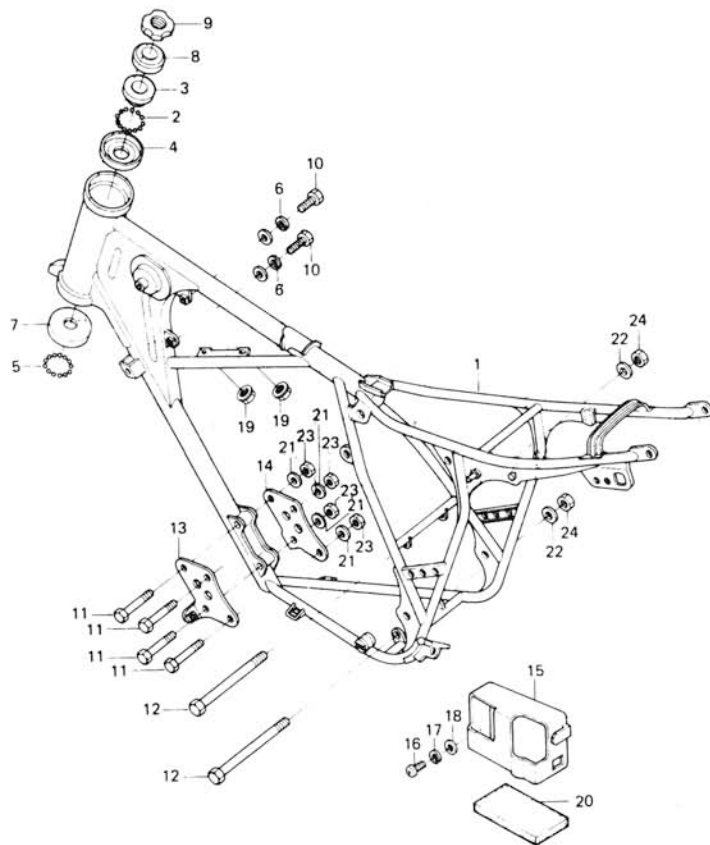

Ref. No.	Part No.	Part Name	Quantity	Remarks
1	32002-1047	FRAME	1	KE175-D1
	32002-1163	FRAME	1	KE175-D2~
2	600A0600	BALL, steel, 3/16"	23	
3	92047-014	CONE, steering stem bearing, upper	1	
4	92048-009	RACE, steering stem bearing, upper	1	
5	600A0800	BALL, steel, 1/4"	19	
6	92027-1181	COLLAR	2	
7	92048-005	RACE, steering stem bearing, lower	1	
8	46098-018	CAP, steering stem	1	
9	92090-022	NUT, steering stem lock	1	
10	110B0640	BOLT, hex head, 6 x 40	2	
11	110B0860	BOLT, hex head, 8 x 60	4	
12	113B10120	BOLT, hex head, 10 x 120	2	
13	13169-1156	PLATE, front engine mounting, L.H.	1	
14	13169-1157	PLATE, front engine mounting, R.H.	1	
15	14025-1048	COVER, battery	1	
16	220B0612	SCREW, pan head, 6 x 12	1	
17	461F0600	WASHER, spring, 6 m/m	1	
18	411B0600	WASHER, plain, 6 m/m	1	
19	92015-1078	NUT, flanged, 6 m/m	2	
20	32103-027	MAT, battery	1	
21	411B0800	WASHER, plain, 8 m/m	4	
22	411B1000	WASHER, plain, 10 m/m	2	
23	92017-013	NUT, lock, 8 m/m	4	
24	92019-021	NUT, lock, 10 m/m	2	

16. Swing Arm, Rear Shock Absorber

Rev. No.		Date	
----------	--	------	--

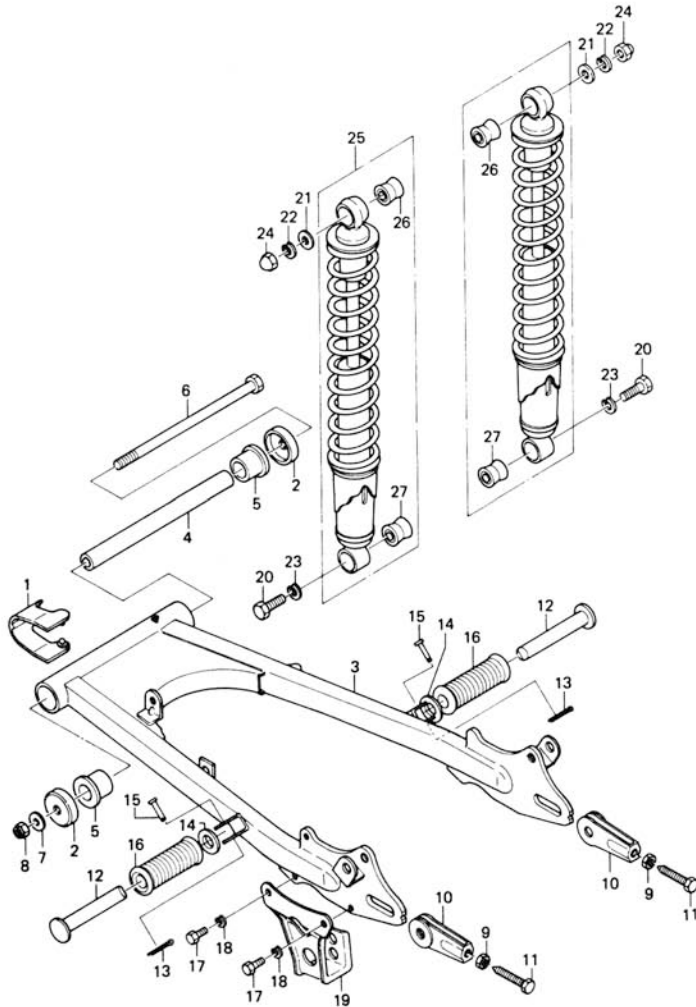

Ref. No.	Part No.	Part Name	Quantity	Remarks
1	11012-1003	GUIDE, chain, front	1	
2	11012-1036	CAP, swing arm	2	
3	33001-1023	SWING ARM	1	KE175-D1
	33001-1061	SWING ARM	1	KE175-D2~
	33001-1065	SWING ARM	1	Use for Australian Market
4	42036-1019	SLEEVE, swing arm, 12.1 x 19 x 202	1	
5	92028-1027	BUSH, swing arm	2	
6	33032-1005	SHAFT, swing arm pivot, 12 x 236	1	
7	410B1200	WASHER, plain, 12 m/m	1	
8	92019-009	NUT, lock, 12 m/m	1	
9	312B0800	NUT, 8 m/m	2	
10	33040-1010	ADJUSTER, chain	2	
11	92001-1179	BOLT, chain adjuster	2	
12	34028-009	BAR, rear footrest	2	
13	550D2015	PIN, cotter, 2.0 x 15	2	
14	92022-199	WASHER, plain	2	
15	92043-079	PIN, rear footrest fitting	2	
16	92076-020	RUBBER, rear footrest	2	
17	110B0612	BOLT, hex head, 6 x 12	2	
18	461F0600	WASHER, spring, 6 m/m	2	
19	55020-1026	GUARD, chain, rear	1	
20	113B1035	BOLT, hex head, 10 x 35	2	
21	411B0800	WASHER, plain, 8 m/m	2	
22	461F0800	WASHER, spring, 8 m/m	2	
23	461F1000	WASHER, spring, 10 m/m	2	
24	92020-007	NUT, cap, 8 m/m	2	
25	45014-1025	SHOCK ABSORBER, rear,	2	
26	92075-1217	BUSHING, shock absorber rubber, upper	2	
27	92075-1216	BUSHING, shock absorber rubber, lower	2	

17. Footrests, Stand

Rev. No.		Date	
----------	--	------	--

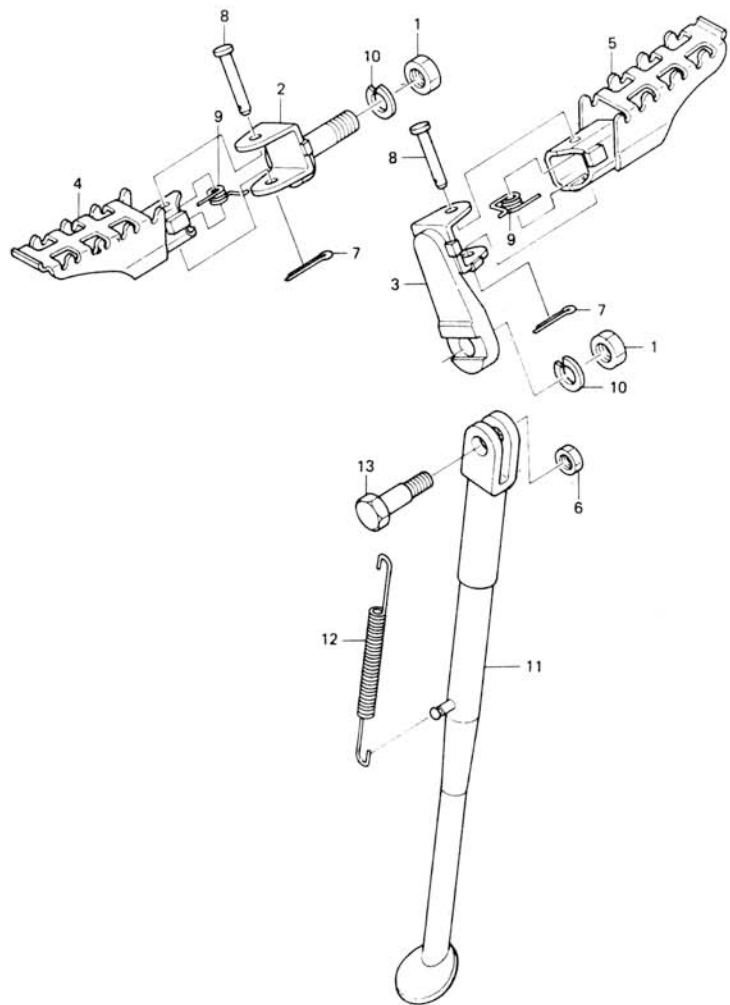

Ref. No.	Part No.	Part Name	Quantity	Remarks
1	315B1400	NUT, 14 m/m	2	
2	34003-1023	BRACKET, front footrest step, L.H.	1	
3	34003-1024	BRACKET, front footrest step, R.H.	1	
4	34028-1013	STEP, front footrest, L.H.	1	
5	34028-1014	STEP, front footrest, R.H.	1	
6	92019-021	NUT, lock, 10 m/m	1	
7	550D2516	PIN, cotter, 2.5 x 16	2	
8	92043-080	PIN, footrest bar	2	
9	92081-1133	SPRING, front footrest step	2	
10	461F1400	WASHER, spring, 14 m/m	2	
11	34024-064	STAND, side	1	
12	34025-008	SPRING, side stand	1	
13	92003-157	BOLT, side stand fitting	1	

18. Brake Pedal, Torque Rod

Rev. No.	Date
----------	------

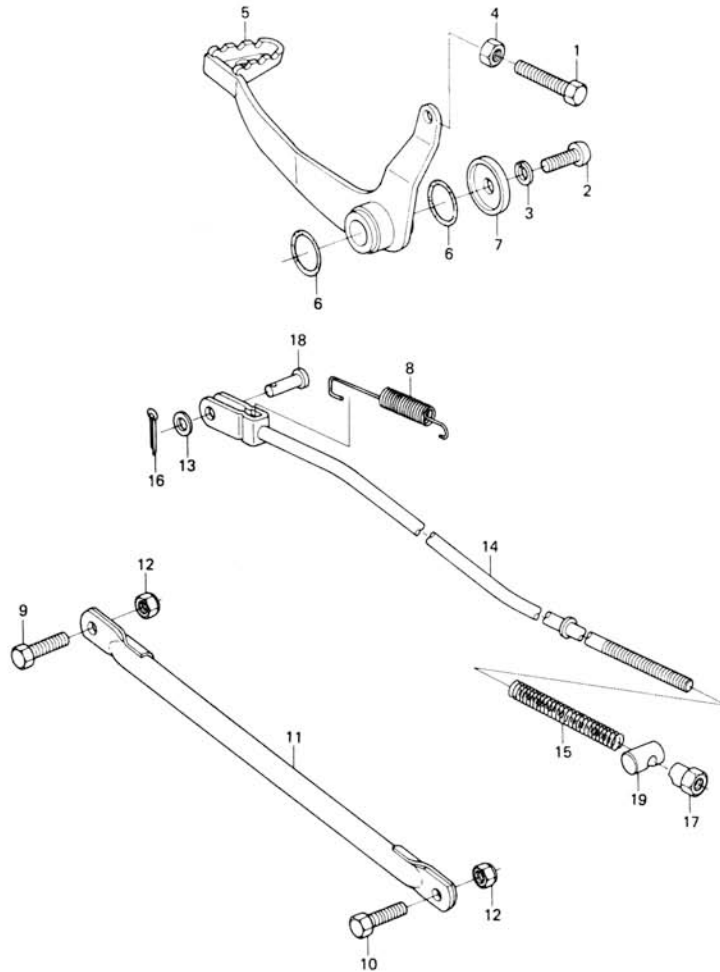

Ref. No.	Part No.	Part Name	Quantity	Remarks
1	110B0620	BOLT, hex head, 6 x 20	1	
2	220B0612	SCREW, pan head, 6 x 12	1	
3	461F0600	WASHER, spring, 6 m/m	1	
4	311B0600	NUT, 6 m/m	1	
5	43001-1020	PEDAL, brake	1	
6	670B2016	"O" RING, 16 m/m	2	
7	92022-284	CAP, brake pedal	1	
8	92081-1071	SPRING, brake pedal	1	
9	113G1022	BOLT, hex head, 10 x 22	1	
10	113G1028	BOLT, hex head, 10 x 28	1	
11	43007-048	ROD, torque, rear brake	1	
12	92019-016	NUT, lock, 10 m/m	2	
13	410B0600	WASHER, plain, 6 m/m	1	
14	43011-1009	ROD, brake	1	
15	43012-001	SPRING, brake rod	1	
16	550D2015	PIN, cotter, 2.0 x 15	1	
17	92015-042	NUT, brake rod	1	
18	92043-064	PIN, brake rod fitting	1	
19	92043-065	PIN, brake rod	1	

19. Handlebar, Grips

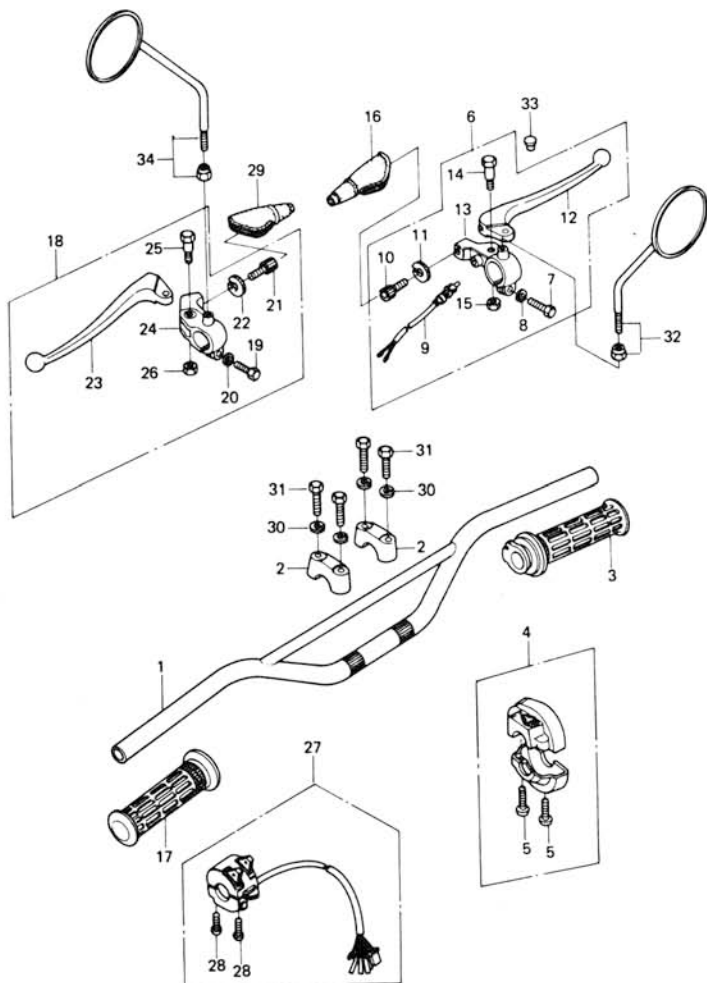

Rev. No.		Date	
----------	--	------	--

Ref. No.	Part No.	Part Name	Quantity		Remarks
			AUSTRALIA	GENERAL	
1	46003-1022	HANDLE BAR	1	1	
2	46012-014	HOLDER, handlebar	2	2	
3	46019-1005	GRIP ASSY, throttle, Flat Black	1	1	
4	46091-1041	HOUSING ASSY, control, R.H, Flat Black	1	1	
5	220B0518A	SCREW, pan head, 5 x 18	2	2	
6	46021-029	LEVER ASSY, front brake	1	1	
7	110N0625	BOLT, hex head, 6 x 25	1	1	
8	410B0600	WASHER, plain, 6 m/m	1	1	
9	27021-004	SWITCH, front brake lamp	1	1	
10	46055-010	SCREW, cable adjuster	1	1	
11	46056-005	NUT, cable adjuster lock	1	1	
12	46058-004	LEVER, front brake	1	1	
13	46060-009-21	HOLDER, front brake lever	1	1	
14	92007-046	BOLT, hex head, 5 x 22	1	1	
15	92019-014	NUT, lock, 5 m/m	1	1	
16	49006-1017	BOOT, lever	1	1	
17	46075-1004	GRIP, rubber, L.H.	1	1	
18	46076-044	LEVER ASSY, clutch	1	1	
19	110N0625	BOLT, hex head, 6 x 25	1	1	
20	410B0600	WASHER, plain, 6 m/m	1	1	
21	46055-003	SCREW, cable adjuster	1	1	
22	46056-005	NUT, cable, adjuster lock	1	1	
23	46092-015	LEVER, clutch	1	1	
24	46094-011-21	HOLDER, clutch lever	1	1	
25	92007-046	BOLT, hex head, 5 x 22	1	1	
26	92019-014	NUT, lock, 5 m/m	1	1	
27	46091-1075	HOUSING ASSY, control, L.H, Flat Black	1	1	
28	220B0522A	SCREW, pan head, 5 x 22	2	2	
29	49006-1017	BOOT, lever	1	1	
30	461F0800	WASHER, spring, 8 m/m	4	4	
31	92007-002	BOLT, handlebar fitting	4	4	
32	56002-020	REAR VIEW OPTION		1	
33	92102-009	CAP, rear view mirror fitting hole	1	1	
34	56003-009	REAR view mirror, L.H.		1	

20. Front Fork

Rev. No.		Date	
----------	--	------	--

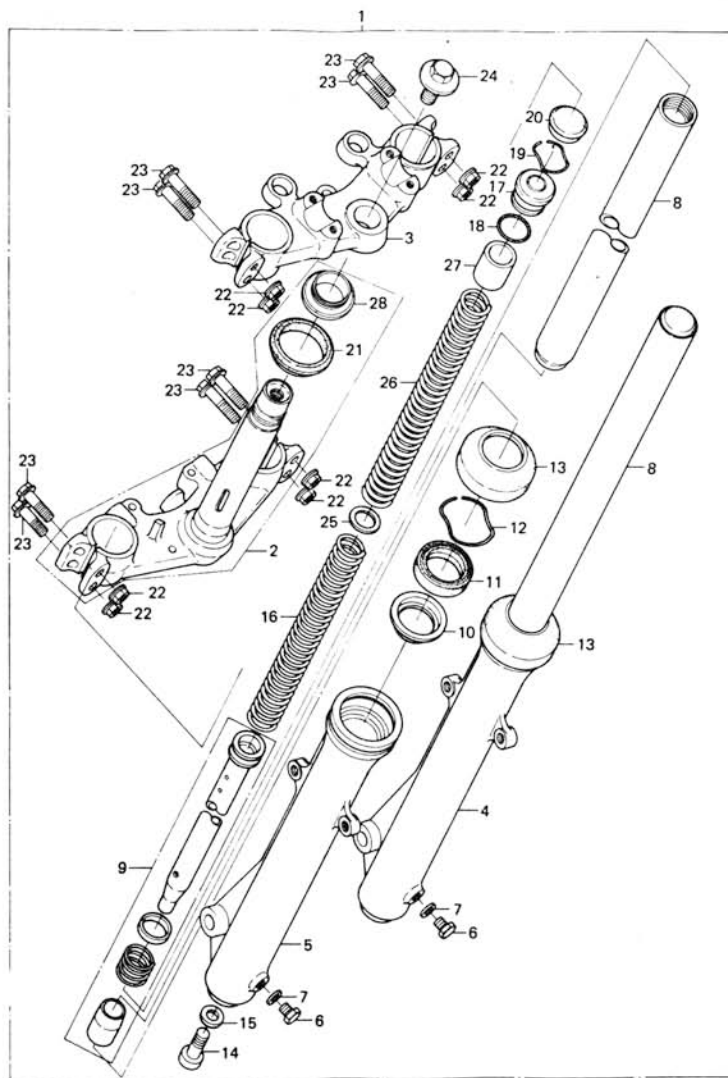

(234-1114)

Ref. No.	Part No.	Part Name	Quantity	Remarks
1	44001-1045	FRONT FORK ASSY	1	
2	44037-1012	STEM, steering	1	
3	44039-1020	HEAD, steering stem	1	
4	44006-1017	TUBE, R.H, fork outer	1	
5	44005-1017	TUBE, L.H, fork outer	1	
6	110B0608	BOLT, hex head, 6 x 8	2	
7	44045-047	GASKET, drain plug	2	
8	44013-1014	TUBE, fork inner	2	
9	44022-1015	CYLINDER, fork	2	
10	92026-1028	SPACER, outer tube	2	
11	92049-1029	OIL SEAL	2	
12	92033-1022	CIRCLIP, fork outer tube	2	
13	92093-1017	DUST SHIELD, fork	2	
14	44041-078	BOLT, fork cylinder	2	
15	44045-051	GASKET, fork cylinder bolt	2	
16	44026-1019	SPRING, fork, lower	2	
17	44029-1012	SEAT, fork spring	2	
18	92055-1060	"O" RING, spring seat	2	
19	92033-1023	CIRCLIP, fork top	2	
20	11012-1061	CAP, rubber, fork top	2	
21	44010-027	SEAL, steering stem	1	
22	92015-1055	NUT, 8 m/m	8	
23	92001-1136	BOLT, hex head, 8 x 45	8	
24	92001-1210	BOLT, steering stem, 14 x 25	1	
25	44028-1005	WASHER, fork spring	2	
26	44026-1034	SPRING, fork, upper	2	
27	92026-1054	COLLAR, fork spring	2	
28	92047-010	CONE, steering stem bearing	1	

21. Fenders (1 / 2)

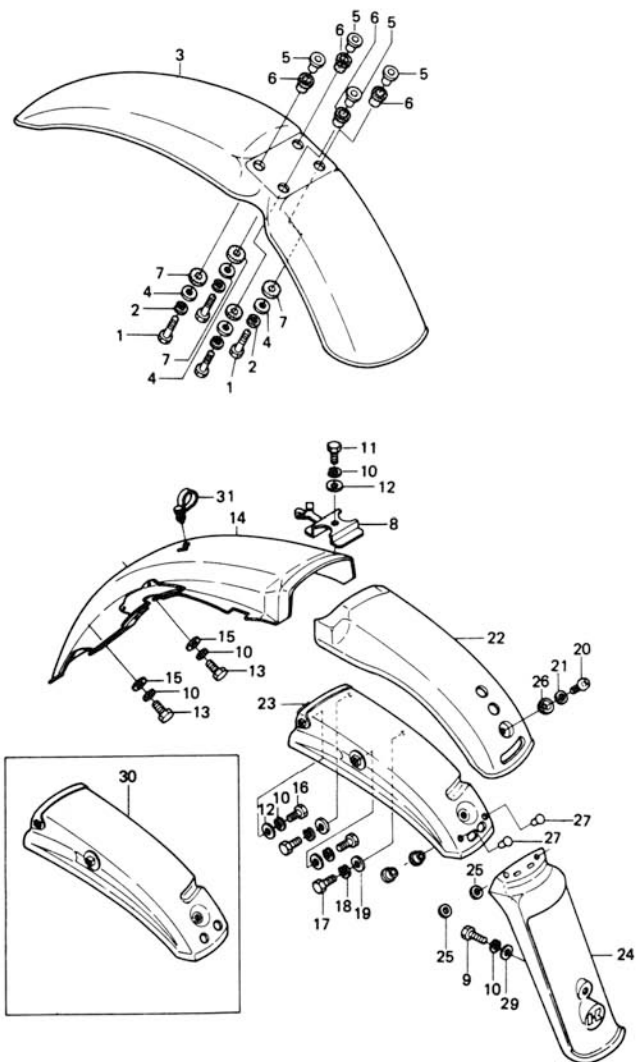

Rev. No.		Date	
----------	--	------	--

Ref. No.	Part No.	Part Name	Quantity		Remarks
			AUSTRALIA	GENERAL	
1	110B0625	BOLT, hex head, 6 x 25	4	4	
2	461F0600	WASHER, spring, 6 m/m	4	4	
3	35004-1024-6L	FENDER, front, Firecracker Red	1	1	
	35004-1024-6K	FENDER, front, Brilliant Blue	1	1	
	35004-1024-6R	FENDER, front, Sunflower Yellow	1	1	KE175-D1
4	92022-125	WASHER, plain, 6 m/m	4	4	
5	92027-194	COLLAR	4	4	
6	92075-103	DAMPER RUBBER, front fender	4	4	
7	92075-121	DAMPER RUBBER, front fender	4	4	
8	13091-1022	HOLDER, wiring harness	1	1	
9	110B0616	BOLT, hex head, 6 x 16	1	1	
10	461F0600	WASHER, spring, 6 m/m	6	5	
11	110B0614	BOLT, hex head, 6 x 14	1	1	
12	411B0600	WASHER, plain, 6 m/m	3	3	
13	110B0616	BOLT, hex head, 6 x 16	2	2	
14	35022-1017	FENDER, rear (Front)	1	1	
15	92022-125	WASHER, plain, 6 m/m	2	2	
16	110B0612	BOLT, hex head, 6 x 12	2	2	
17	110B0818	BOLT, hex head, 8 x 18	2	2	
18	461F0800	WASHER, spring, 8 m/m	2	2	
19	410B0800	WASHER, plain, 8 m/m	2	2	
20	220B0612	SCREW, pan head, 6 x 12	1	1	
21	410B0600	WASHER, plain, 6 m/m	1	1	
22	35022-1018-6L	FENDER, rear (Rear), Firecracker Red	1	1	
	35022-1018-6K	FENDER, rear (Rear), Brilliant Blue	1	1	
	35022-1018-6R	FENDER, rear (Rear), Sunflower Yellow	1	1	KE175-D1
23	35034-1050	REINFORCE, rear fender	1	1	
24	35037-023	FLAP, rear fender	1	1	
25	92022-125	WASHER, plain, 6 m/m	2	2	

21. Fenders (2 / 2)

Rev. No.	Date
----------	------

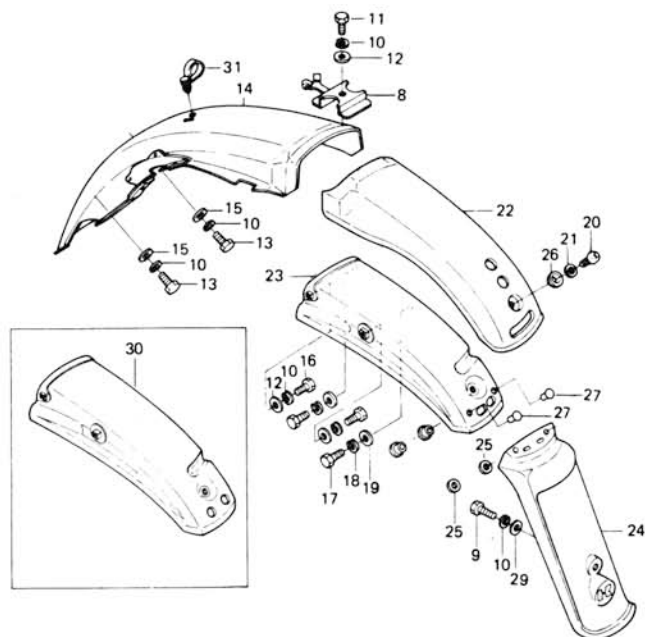
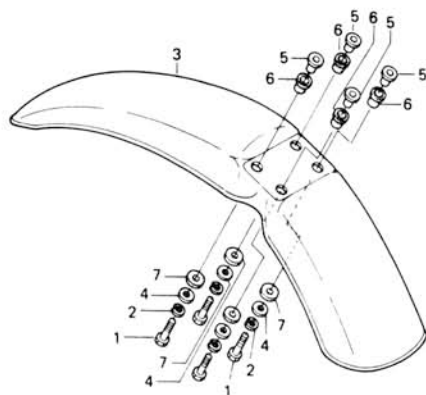

Ref. No.	Part No.	Part Name	Quantity		Remarks
			AUSTRALIA	GENERAL	
26	92027-1181	COLLAR, rear fender	2		
27	92039-1018	RIVET, 6 x 19	2		
28	92027-1018	COLLAR, rear fender	1	1	
29	92022-125	WASHER, plain, 6 m/m	1		
30	35034-1029	REINFORCE, rear fender		1	
31	92037-1163	CLAMP, harness, rear	1	1	

22. Wheels

Rev. No.		Date	
----------	--	------	--

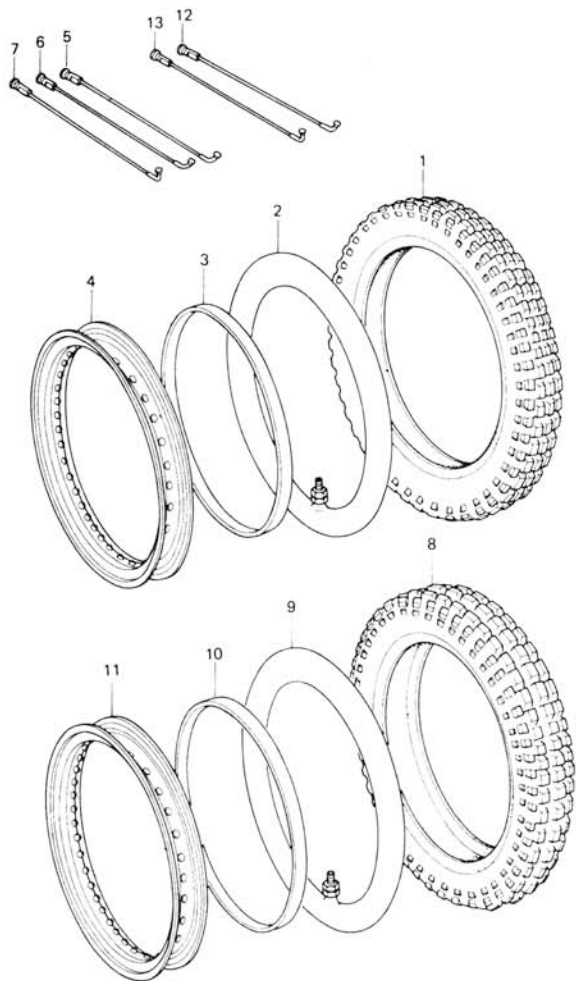

Ref. No.	Part No.	Part Name	Quantity	Remarks
1	41002-1083	TIRE, front, 2.75-21 4PR, Y-963C	1	
2	41022-1021	TUBE, front tire, 2.75/3.00-21, TR6	1	
3	41023-1007	BAND, rim, 2.75/3.50-21	1	
4	41025-1012	RIM, front, 1.60 x 21	1	
5	41027-5021	SPORK ASSY, front inner, R.H.	18	245 m/m x 118°
6	41027-5022	SPORK ASSY, front inner, L.H.	9	227 m/m x 98°
7	41028-5019	SPORK ASSY, front outer, L.H.	9	227 m/m x 88°
8	41002-1084	TIRE, rear, 3.50-18 4PR, Y-963C	1	
9	41022-1022	TUBE, rear tire, 3.50/3.75/4.10-18, TR6	1	
10	41023-1008	BAND, rim, 2.50/3.75-18	1	
11	41025-1013	RIM, rear, 1.85 x 18	1	
12	41027-070	SPORK ASSY, rear inner	18	171 m/m x 106°
13	41028-069	SPORK ASSY, rear outer	18	170 m/m x 80°

23. Front Hub

Rev. No.		Date	
----------	--	------	--

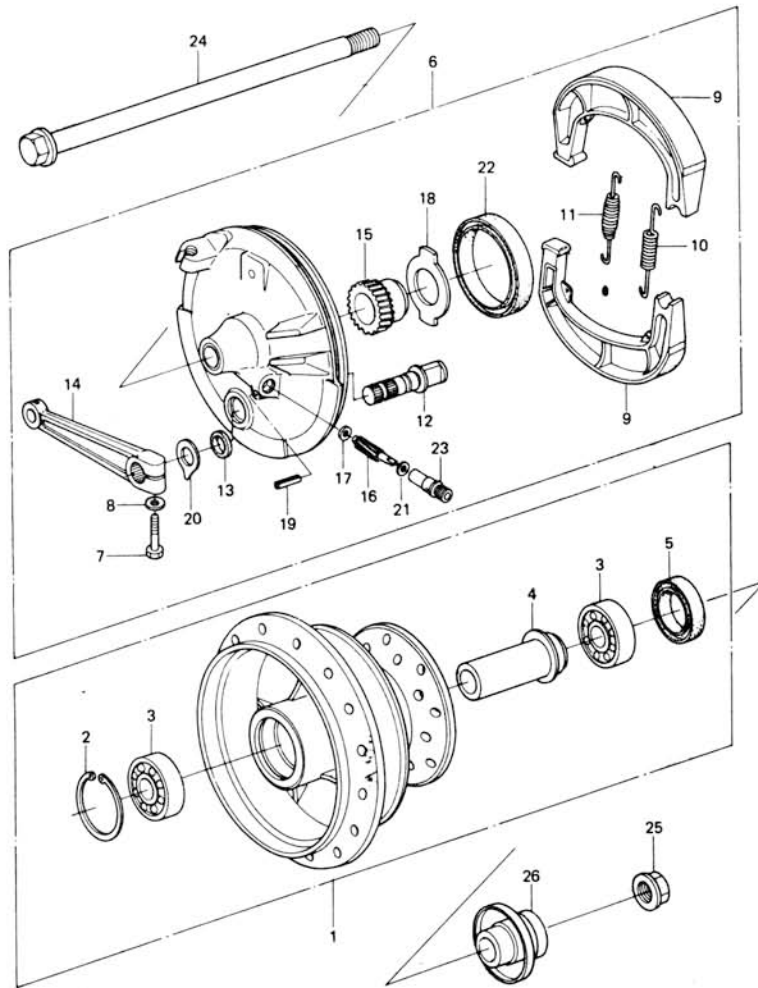

Ref. No.	Part No.	Part Name	Quantity	Remarks
1	41034-1014	DRUM ASSY, front brake	1	
2	481J3700	CIRCLIP, 37 m/m	1	
3	601B6301	BEARING, ball, #6301C3	2	
4	92027-1097	COLLAR, front brake drum, L = 34 m/m	1	
5	92050-059	OIL SEAL, front brake drum	1	
6	41035-1016	PANEL ASSY, front brake	1	
7	110G0625	BOLT, hex head, 6 x 25	1	
8	410B0600	WASHER, plain, 6 m/m	1	
9	41048-015	SHOE, brake	2	
10	41049-002	SPRING, brake shoe	1	
11	41049-011	SPRING, brake shoe	1	
12	41050-1010	CAM, brake, front	1	
13	41051-001	DUST SHIELD, brake cam shaft	1	
14	41053-1012	LEVER, brake cam, front	1	
15	41060-1017	GEAR, speedometer, 24T	1	
16	41060-1018	PINION, speedometer, 8T	1	
17	41063-001	WASHER, thrust	1	
18	41064-006	RECEIVER, speedometer gear	1	
19	41082-001	SPRING PIN	1	
20	41085-1003	INDICATOR, brake shoe	1	
21	92022-1062	WASHER, plain	1	
22	92050-010	OIL SEAL, front brake panel	1	
23	92087-1002	BUSHING, meter gear	1	
24	41068-1012	AXLE, front, 12 x 215	1	
25	92015-1034	NUT, 12 m/m	1	
26	92027-1098	COLLAR, front axle	1	

24. Rear Hub (1 / 2)

Rev. No.		Date	
----------	--	------	--

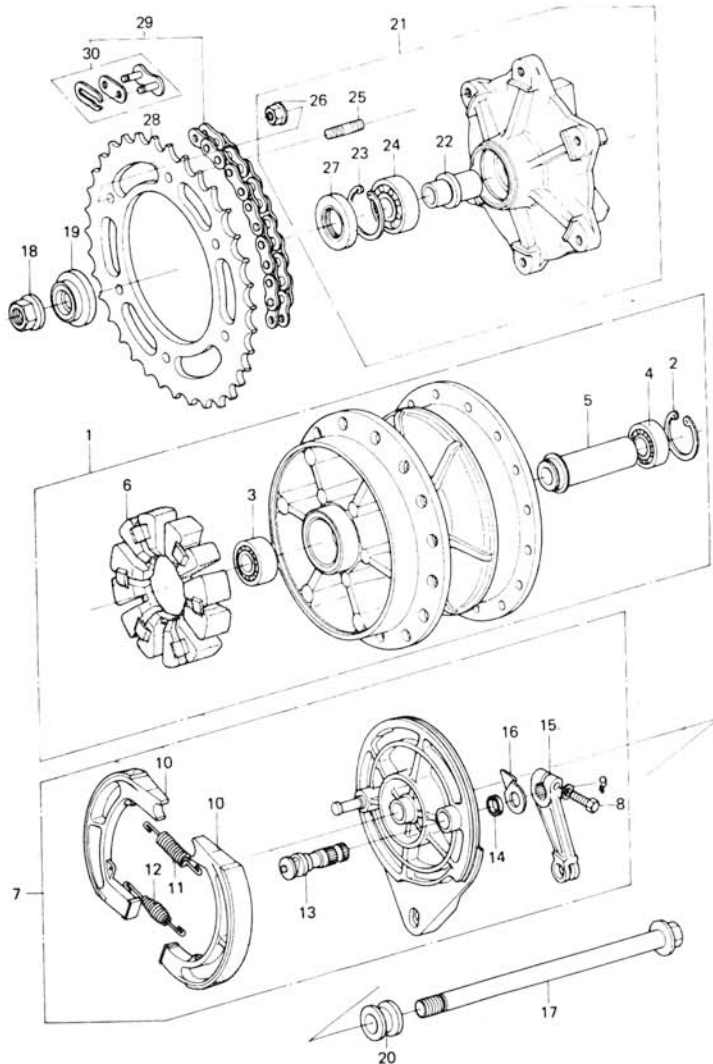

Ref. No.	Part No.	Part Name	Quantity		Remarks
			AUSTRALIA	GENERAL	
1	41034-1015	DRUM ASSY, rear brake	1	1	
2	481J3500	CIRCLIP, 35 m/m	1	1	
3	601B6202	BEARING, ball, #6202C3	1	1	
4	601B6202U	BEARING, ball, #6202UC3	1	1	
5	92027-1099	COLLAR, rear brake drum, L = 86 m/m	1	1	
6	92075-1068	DAMPER, rear hub shock	1	1	
7	41035-1017	PANEL ASSY	1	1	
8	110G0625	BOLT, hex head, 6 x 25	1	1	
9	410B0600	WASHER, plain, 6 m/m	1	1	
10	41048-1012	SHOE, brake	2	2	
11	41049-002	SPRING, brake shoe	1	1	
12	41049-011	SPRING, brake shoe	1	1	
13	41050-1011	CAM, brake, rear	1	1	
14	41051-001	DUST SHIELD, brake cam shaft	1	1	
15	41053-1013	LEVER, brake cam, rear	1	1	
16	41085-017	INDICATOR, brake shoe	1	1	
17	41068-1013	AXLE, rear, 15 x 263	1	1	
18	92015-1032	NUT, 14 m/m	1	1	
19	92027-1100	COLLAR, rear axle, L.H., L = 21 m/m	1	1	
20	92027-1101	COLLAR, rear axle, R.H., L = 16 m/m	1	1	
21	42033-1007	COUPLING ASSY, rear hub	1	1	
22	42036-1020	SLEEVE, rear hub coupling	1	1	
23	481J4200	CIRCLIP, 42 m/m	1	1	
24	601B6004	BEARING, ball, #6004C3	1	1	
25	92004-1015	STUD, 8 x 17	6	6	
26	92015-1022	NUT, 8 m/m	6	6	
27	92050-060	OIL SEAL	1	1	

24. Rear Hub (2 / 2)

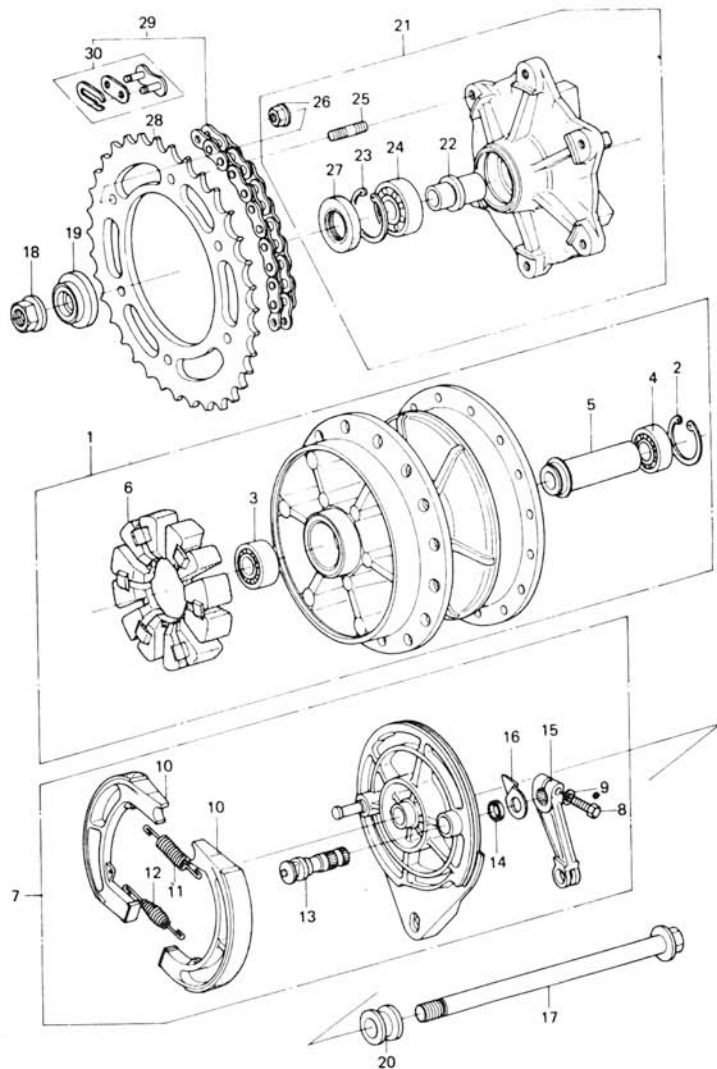

Ref. No.	Part No.	Part Name	Quantity		Remarks
			AUSTRALIA	GENERAL	
28	42041-1030	SPROCKET, rear, 48T, STD*		1	KE175-D2
	42041-1046	SPROCKET, rear, 47T	(1)	(1)	} RACING USE ONLY
	42041-1047	SPROCKET, rear, 49T	(1)	(1)	
	42041-1040	SPROCKET, rear, 50T	(1)	(1)	
29	92057-1014	CHAIN ASSY, drive, 118L (JE) EK428SH-PG		(1)	KE175-D2
		EK428SH-PG			
30	92058-005	JOINT ASSY, drive chain	1	1	

25. Fuel Tank

Rev. No.		Date	
----------	--	------	--

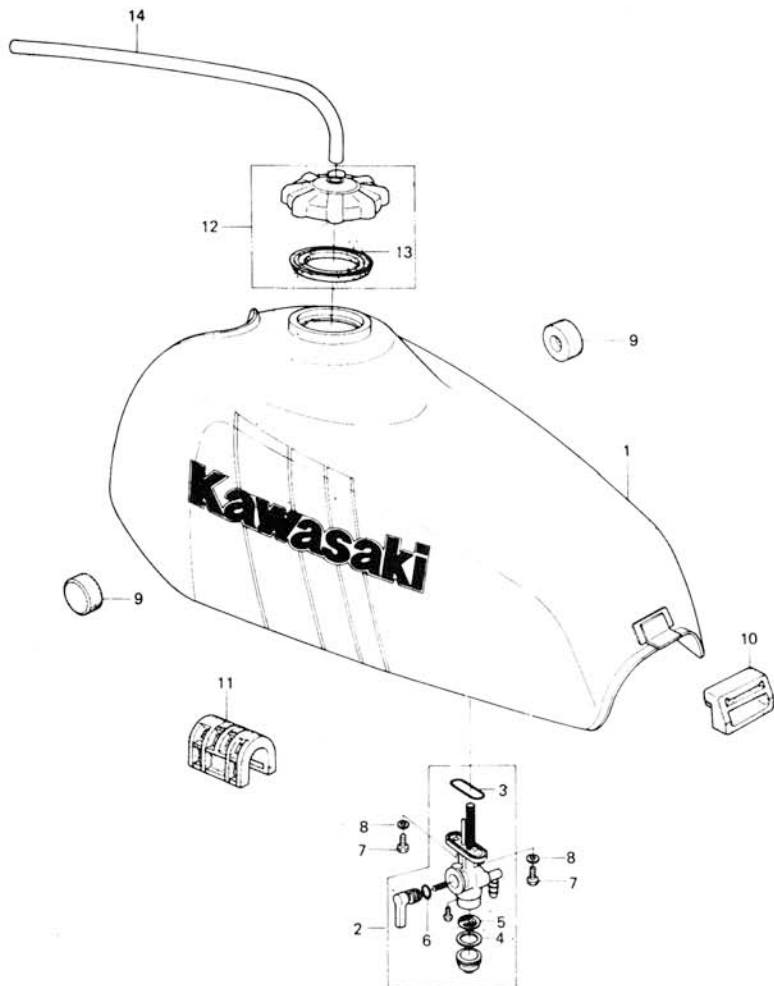

Ref. No.	Part No.	Part Name	Quantity	Remarks
1	51001-5052	TANK, fuel, Firecracker Red	1	
	51001-1013-C9	TANK, fuel, Brilliant Blue	1	
	51001-1013-7H	TANK, fuel, Sunflower Yellow	1	KE175-D1
2	51023-1020	TAP ASSY, fuel	1	
3	51039-003	"O" RING, fuel tap	1	
4	11009-1013	GASKET, fuel cock cup	1	
5	14043-1002	STRAINER, fuel	1	
6	67082010	"O" RING, 10 m/m	1	
7	92001-1091	BOLT, hex head, 6 x 20	2	
8	92022-183	WASHER, plain, 6 m/m	2	
9	92075-101	DAMPER, fuel tank, front	2	
10	92075-1074	DAMPER, fuel tank, rear	1	
11	92075-284	DAMPER, fuel tank	1	
12	51048-1004	CAP ASSY, fuel tank	1	
13	51059-006	GASKET, fuel tank cap	1	
14	702A05300	TUBE, rubber, 5 x 300	1	

26. Oil Tank

Rev. No.		Date	
----------	--	------	--

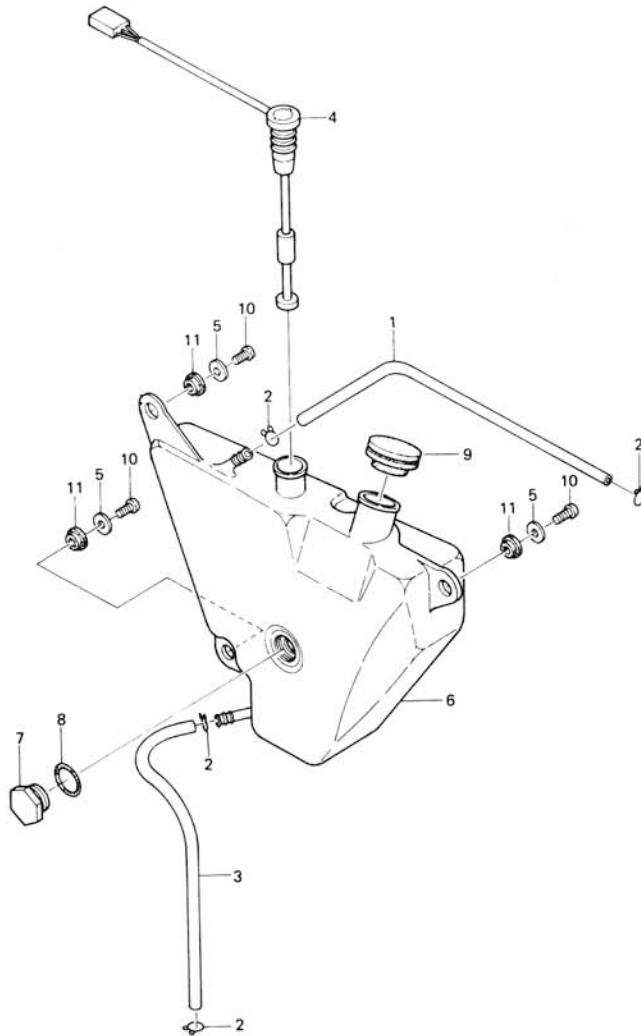

Ref. No.	Part No.	Part Name	Quantity	Remarks
1	700Q05470	TUBE, vinyl, 5 x 470	1	
2	92037-010	CLAMP	4	
3	92059-107	TUBE, vinyl, 4.5 x 400	1	
4	27010-1031	SWITCH, oil check	1	
5	410B0800	WASHER, plain, 8 m/m	3	
6	52001-1006	TANK, oil	1	
7	52015-002	GAUGE, oil level	1	
8	92055-051	"O" RING, 20 m/m	1	
9	52003-023	CAP, oil tank	1	
10	92011-026	SCREW, pan head, 6 m/m	3	
11	92075-172	DAMPER	3	

27. Side Covers, Chain Cover, Engine Guard

Rev. No.	Date
----------	------

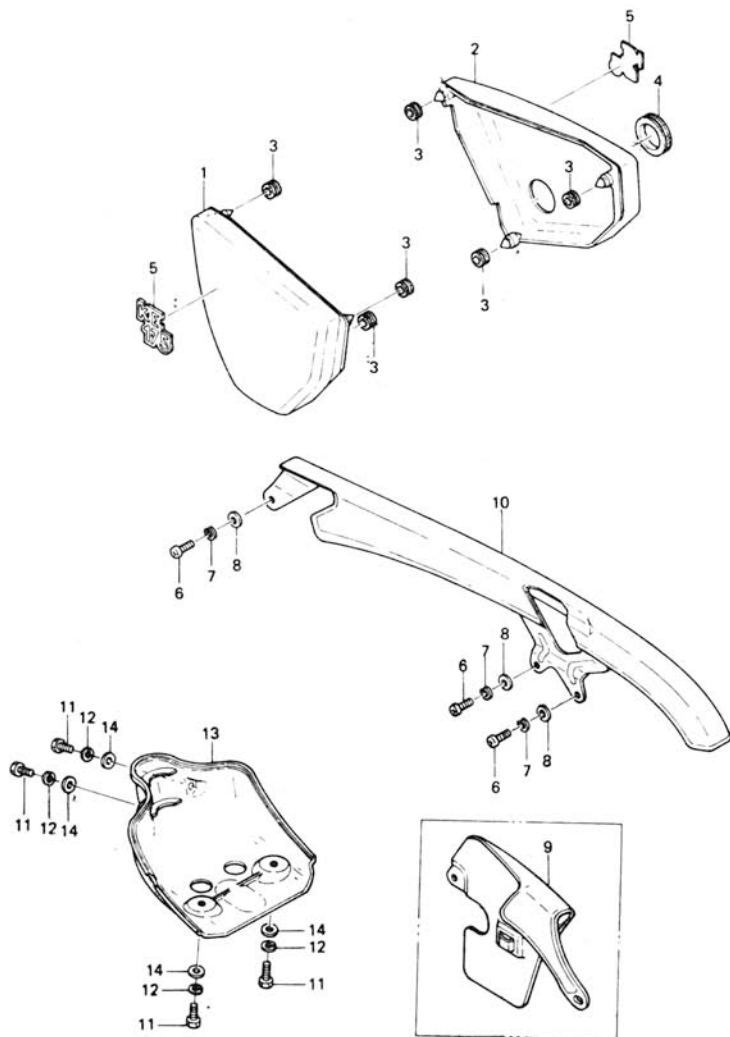

Ref. No.	Part No.	Part Name	Quantity		Remarks
			AUSTRALIA	GENERAL	
1	36001-1099-6L	COVER, side, L.H, Firecracker Red	1	1	
	36001-1099-6K	COVER, side, L.H, Brilliant Blue	1	1	
	36001-1099-6R	COVER, side, L.H, Sunflower Yellow	1	1	KE175-D1
2	36001-1100-6L	COVER, side, R.H, Firecracker Red	1	1	
	36001-1100-6K	COVER, side, R.H, Brilliant Blue	1	1	
	36001-1100-6R	COVER, side, R.H, Sunflower Yellow	1	1	KE175-D1
3	92071-056	GROMMET	6	6	
4	92071-080	GROMMET	1	1	
5	56018-1035	MARK,side cover	2	2	
6	220B0616	SCREW, pan head, 6 x 16	3	2	
7	461F0600	WASHER, spring, 6 m/m	3	2	
8	411B0600	WASHER, plain, 6 m/m	3	2	
9	36014-1007	CASE, chain, Black		1	
10	36014-1017	CASE, chain, Fiat Black		1	
11	110B0616	BOLT, hex head, 6 x 16	4	4	
12	461F0600	WASHER, spring, 6 m/m	4	4	
13	55020-1025	GUARD, engine	1	1	
14	92022-240	WASHER, plain, 6 m/m	4	4	

28. Dual Seat

Rev. No.		Date	
----------	--	------	--

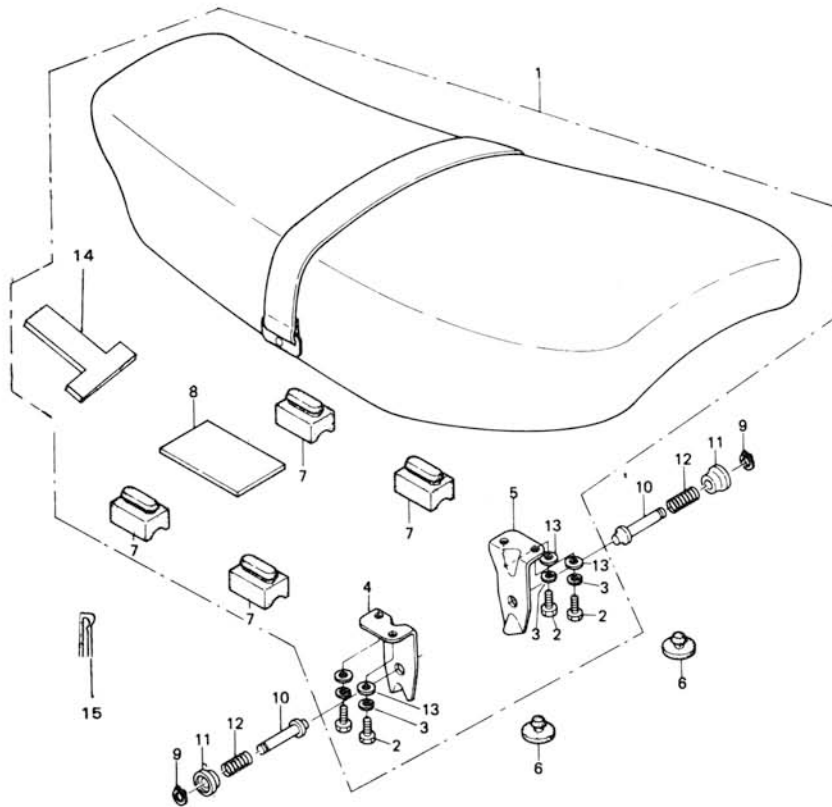

Ref. No.	Part No.	Part Name	Quantity		Remarks
			AUSTRALIA	GENERAL	
1	53001-1057	SEAT ASSY, dual		1	
2	110B0614	BOLT, hex head, 6 x 14	4	4	
3	461F0600	WASHER, spring, 6 m/m	4	4	
4	32046-1030	BRACKET, seat catch, L.H.	1	1	
5	32046-1031	BRACKET, seat catch, R.H.	1	1	
6	92075-099	DAMPER	2	2	
7	92075-216	DAMPER	4	4	
8	92075-224	DAMPER	1	1	
9	92033-1039	CIRCLIP, 8 m/m	2	2	
10	92043-1036	PIN, seat stopper	2	2	
11	92077-1007	KNOB, seat stopper	2	2	
12	92081-1135	SPRING, seat stopper	2	2	
13	411B0600	WASHER, plain, 6 m/m	4	4	
14	11034-1157	BRACKET		1	
15	92043-1062	PIN		1	

29. Cables

Rev. No.		Date	
----------	--	------	--

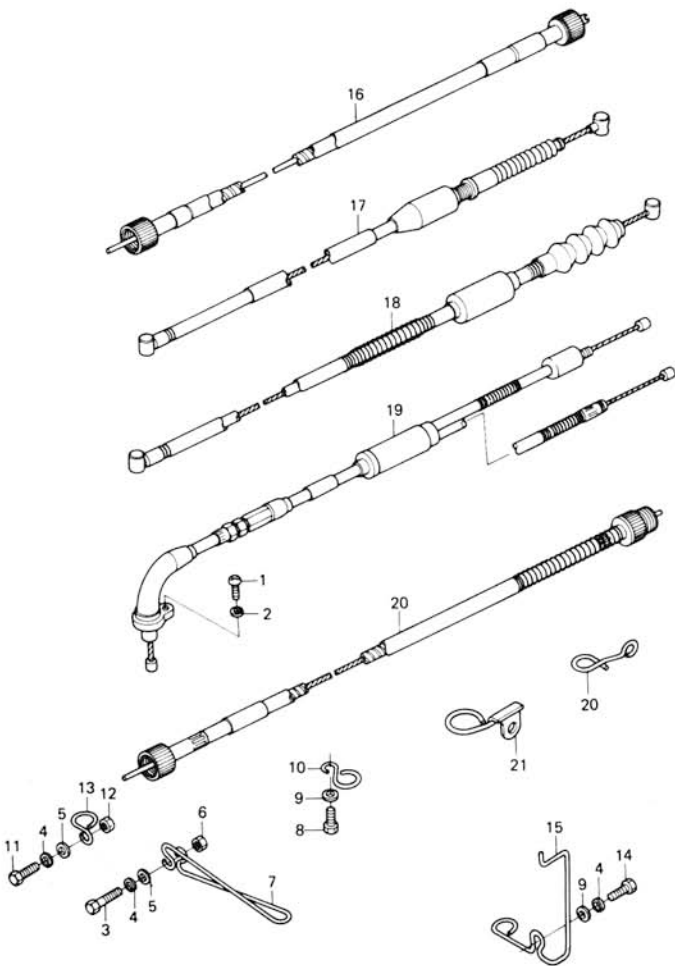

Ref. No.	Part No.	Part Name	Quantity	Remarks
1	220B0510A	SCREW, pan head, 5 x 10	1	
2	461F0500	WASHER, spring, 5 m/m	1	
3	110B0625	BOLT, hex head, 6 x 25	1	
4	461F0600	WASHER, spring, 6 m/m	3	
5	410B0600	WASHER, plain, 6 m/m	2	
6	311B0600	NUT, 6 m/m	1	
7	92037-1014	CLAMP	1	
8	110B0612	BOLT, hex head, 6 x 12	1	
9	411B0600	WASHER, plain, 6 m/m	2	
10	92037-1034	CLAMP	1	
11	110B0618	BOLT, hex head, 6 x 18	1	
12	311B0600	NUT, 6 m/m	1	
13	92037-1033	CLAMP	1	
14	110B0612	BOLT, hex head, 6 x 12	1	
15	92037-1084	CLAMP	1	
16	54001-1011	CABLE, speedometer	1	
17	54005-1014	CABLE, front brake	1	
18	54011-1014	CABLE, clutch	1	
19	54012-1052	CABLE, throttle control	1	
20	54018-1007	CABLE, tachometer	1	
21	92037-1015	CLAMP	1	
22	92037-1016	CLAMP	1	

30. Speedometer, Tachometer

Rev. No.	Date
----------	------

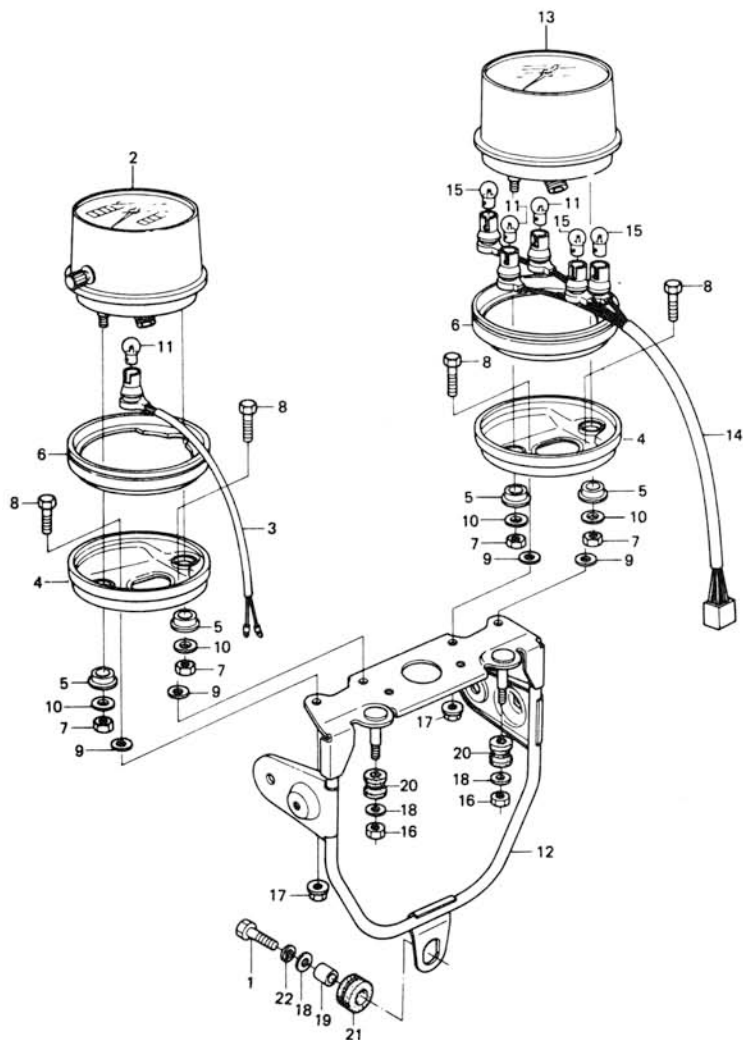

Ref. No.	Part No.	Part Name	Quantity		Remarks
			AUSTRALIA	GENERAL	
1	110B0625	BOLT, hex head, 6 x 25	1	1	
2	25005-1055	SPEEDOMETER, Km/h	1	1	
3	25010-021	SOCKET, speedometer	1	1	
4	25012-025	COVER, meter	2	2	
5	25019-013	SHOCK DAMPER, meter	4	4	
6	25019-031	SHOCK DAMPER, meter	2	2	
8	92003-204	BOLT, hex head, 6 x 14	4	4	
9	92022-263	WASHER, meter, 6 x 18 x 0.5	2	2	
10	92022-263	WASHER, meter, 5.2 x 16 x 1.2	4	4	
12	25008-1019	BRACKET, meter	1	1	
13	25015-1045	TACHOMETER ASSY, X1000 r/min		1	KE175-D2~
14	23008-1050	SOCKET ASSY, tachometer	1	1	
15	92069-024	BULB, 6V1.7W	3	3	
16	311B0600	NUT, 6 m/m	2	2	
17	92015-1078	NUT, flanged, 6 m/m	4	4	
18	92022-125	WASHER, plain, 8 m/m	3	3	
19	92027-241	COLLAR	1	1	
20	92075-024	DAMPER, meter bracket	2	2	
21	92075-209	DAMPER, meter bracket	1	1	
22	461F0600	WASHER, spring, 6 m/m	1	1	

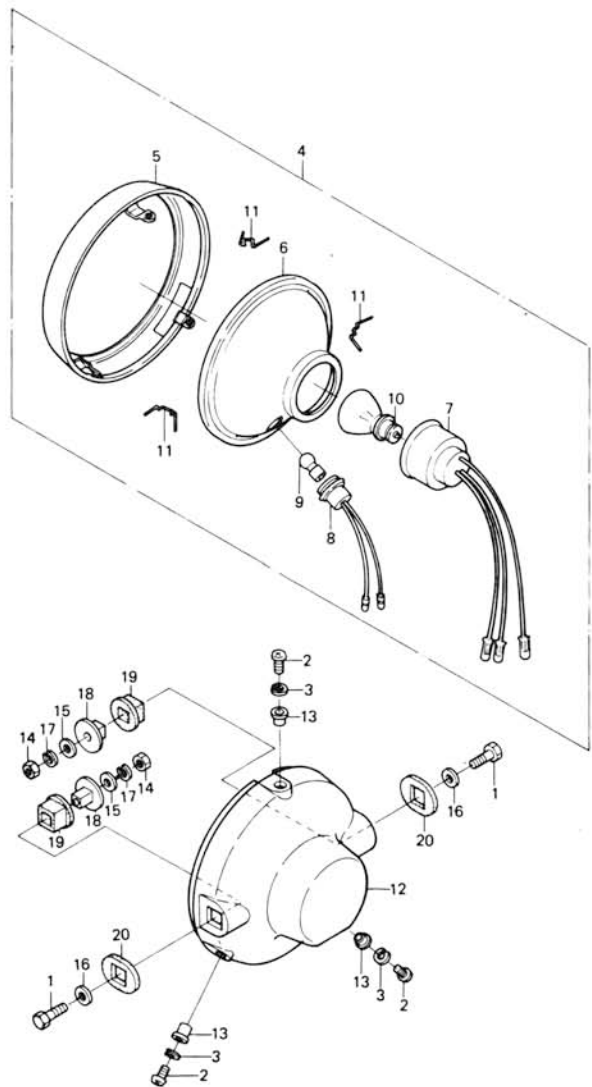

Ref. No.	Part No.	Part Name	Quantity	Remarks
1	110N0832	BOLT, hex head, 8 x 32	2	
2	220B0512A	SCREW, pan head, 5 x 12	3	
3	461F0500	WASHER, spring, 5 m/m	3	
4	23004-1029	LAMP UNIT, head	1	
5	23006-1007	RIM, head lamp	1	
6	23007-1020	LENS UNIT, head lamp	1	
7	23008-1043	SOCKET, head lamp	1	
8	23008-1044	SOCKET, parking lamp	1	
9	92069-053	BULB, 6V3W	1	
10	92069-1006	BULB, 6V 35/35W	1	
11	92081-1144	CLAMP, head lamp lens unit	3	
12	23005-1007 6Z	BODY, head lamp	1	
13	23021-010	WASHER	3	
14	311B0800	NUT, 8 m/m	2	
15	411B0800	WASHER, plain, 8 m/m	2	
16	411D0800	WASHER, plain, 8 m/m	2	
17	461F0800	WASHER, spring, 8 m/m	2	
18	92027-1105	COLLAR, head lamp	2	
19	92075-1077	DAMPER RUBBER	2	
20	92075-1078	DAMPER RUBBER	2	

32. Tail Lamp

Rev. No.		Date	
----------	--	------	--

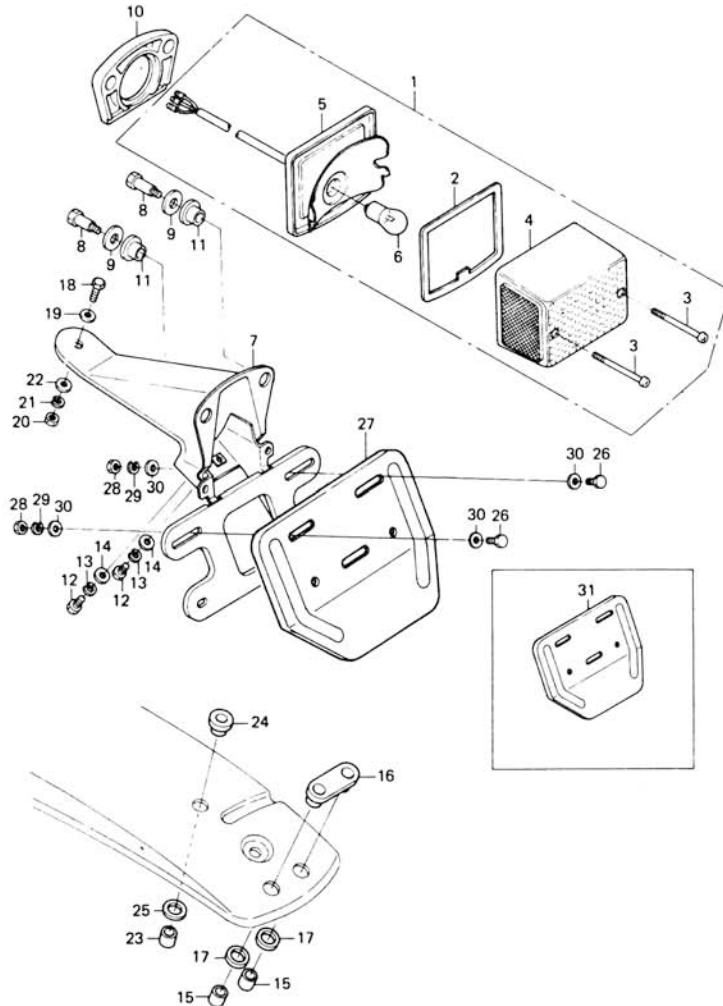

Ref. No.	Part No.	Part Name	Quantity		Remarks
			AUSTRALIA	GENERAL	
1	23025 1006	LAMP UNIT, tail	1	1	
2	11009 1078	GASKET, tail lamp lens	1	1	
3	220R0440A	SCREW, pan head, 4 x 40	2	2	
4	23026 1003	LENS, tail lamp	1	1	
5	23027 1002	CASE, tail lamp	1	1	
6	92069 074	BULB, 12V 32/3 CP	1	1	
7	23036 1023	BRACKET, license plate	1	1	
8	92001 1118	BOLT, hex head	2	2	
9	92022 195	WASHER, plain	2	2	
10	92075 1094	DAMPER RUBBER, tail lamp	1	1	
11	92075 1095	DAMPER RUBBER	2	2	
12	11080628	BOLT, hex head, 6 x 28	2	2	
13	461F0600	WASHER, spring, 6 m/m	2	2	
14	92022 125	WASHER, plain, 6 m/m	2	2	
15	92027 156	COLLAR	2	2	
16	92075 1005	DAMPER RUBBER	1	1	
17	92075 310	DAMPER RUBBER	2	2	
18	11080628	BOLT, hex head, 6 x 28	1	1	
19	411B0600	WASHER, plain	1	1	
20	311B0600	NUT, 6 m/m	1	1	
21	461F0600	WASHER, spring, 6 m/m	1	1	
22	92022 125	WASHER, plain, 6 m/m	1	1	
23	92027 156	COLLAR	1	1	
24	92075 1004	DAMPER RUBBER	1	1	
25	92075 310	DAMPER RUBBER	1	1	
26	11080620	BOLT, hex head, 6 x 20	2	2	
27	11034 1569	BRACKET, license plate	1	1	
28	311B0600	NUT, 6 m/m	2	2	
29	461F0600	WASHER, spring, 6 m/m	2	2	
30	92022 125	WASHER, plain	4	4	
31	11034 1117	BRACKET, license plate	1	1	

33. Turn Signal Lamps

Rev. No.		Date	
----------	--	------	--

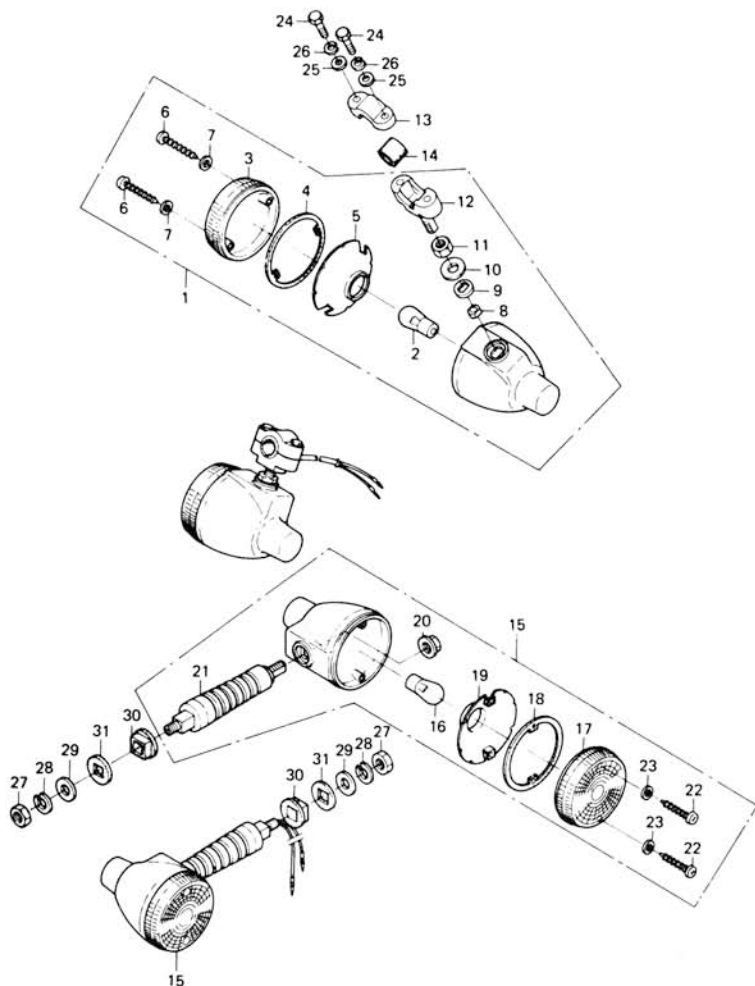

Ref. No.	Part No.	Part Name	Quantity	Remarks
1	23037-1039	LAMP ASSY, front turn signal	2	
2	92069-0b6	BULB, 6V 21CP	2	
3	23048-1011	LENS, turn signal lamp	2	
4	11009-1128	GASKET, turn signal lamp lens	2	
5	23035-1003	REFLECTOR, turn signal lamp	2	
6	92009-1056	SCREW, tapping	4	
7	23058-002	WASHER, plain, 4 m/m	4	
8	92027-1182	COLLAR, front turn signal lamp	2	
9	11009-1133	GASKET, turn signal lamp bracket	2	
10	92022-1137	WASHER, plain, 10.5 x 24 x 1.6	2	
11	92015-1073	NUT, turn signal lamp bracket	2	
12	23051-1028	BRACKET, front turn signal lamp	2	
13	23051-1018	BRACKET, turn signal lamp	2	
14	23066-003	DAMPER RUBBER	2	
15	23037-1040	LAMP ASSY, rear turn signal	2	
16	92069-056	BULB, 6V 21CP	2	
17	23048-1011	LENS, turn signal lamp	2	
18	11009-1128	GASKET, turn signal lamp lens	2	
19	23035-1003	REFLECTOR, turn signal lamp	2	
20	92015-1072	NUT, turn signal lamp	2	
21	23051-1029	BRACKET, rear turn signal lamp	2	
22	92009-1056	SCREW, tapping	4	
23	23058-002	WASHER, plain, 4 m/m	4	
24	110B0530A	BOLT, hex head, 5 x 30	4	
25	410B0500	WASHER, plain, 5 m/m	4	
26	461F0500	WASHER, spring, 5 m/m	4	
27	315B1000	NUT, 10 m/m	2	
28	461F1000	WASHER, spring, 10m/m	2	
29	92022-1071	WASHER, 10.5 x 32 x 1.6	2	
30	92075-1079	DAMPER RUBBER	2	
31	92075-1080	DAMPER RUBBER	2	

34. Ignition Switch, Reflector Lock

Rev. No.	Date
----------	------

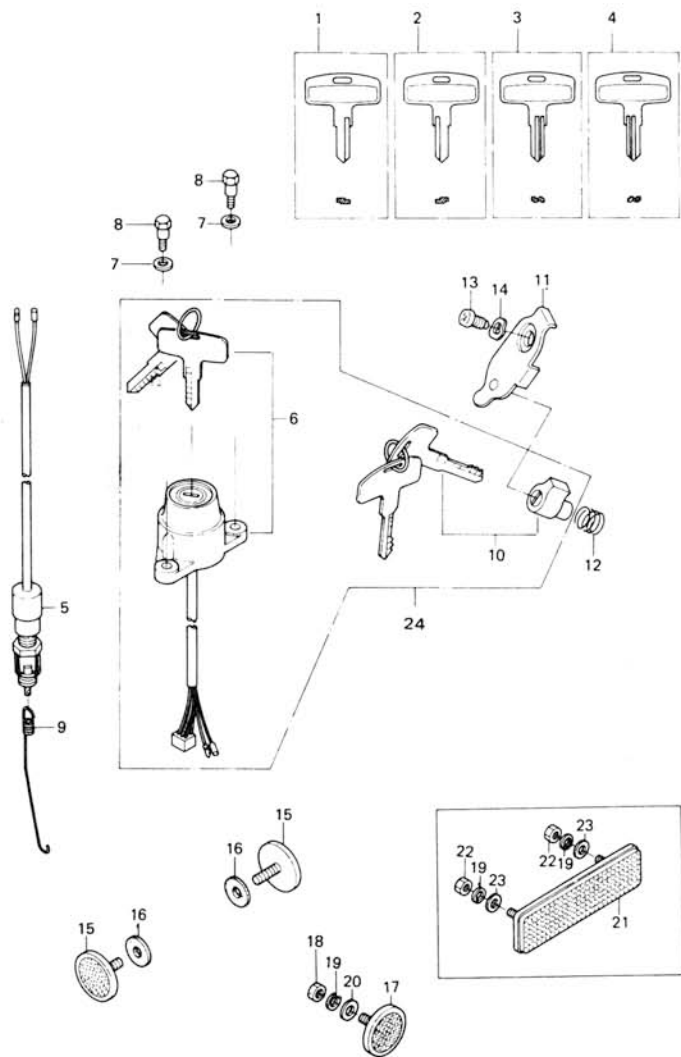

Ref. No.	Part No.	Part Name	Quantity		Remarks
			AUSTRALIA	GENERAL	
1	27008-1024	KEY, blank	(1)	(1)	} Option
2	27008-1025	KEY, blank	(1)	(1)	
3	27008-1026	KEY, blank	(1)	(1)	
4	27008-1027	KEY, blank	(1)	(1)	
5	27010-025	SWITCH, brake lamp	1	1	
6	27005-1037	SWITCH ASSY, ignition	1	1	
7	410B0800	WASHER, plain, 8 m/m	2	2	
8	92007-027	BOLT, 6 m/m	2	2	
9	92081-1082	SPRING, brake lamp switch	1	1	
10	27016-035	LOCK ASSY, steering	1	1	
11	27031-005	CAP, steering lock	1	1	
12	27032-001	SPRING, steering lock	1	1	
13	92008-007	SCREW, tapping	1	1	
14	92097-003	WASHER, wave	1	1	
15	28012-016	REFLECTOR, reflex	2	2	
16	92094-011	DAMPER RUBBER, reflector	2	2	
17	28012-1001	REFLECTOR, rear reflex	1		
18	312B0500A	NUT, 5 m/m	1		
19	461F0500	WASHER, spring, 5 m/m	1	2	
20	92022-104	WASHER, plain	1		
21	28012-1005	REFLECTOR, rear reflex		1	
22	311B0500A	NUT, 5 m/m		2	
23	411B0500	WASHER, plain, 5 m/m		2	
24	27004-5061	LOCK ASSY, KE175-D1, attached two keys only	(1)	(1)	} Option
	27016-5032	LOCK ASSY, HELMET			

35. Electrical Equipments

Rev. No.		Date	
----------	--	------	--

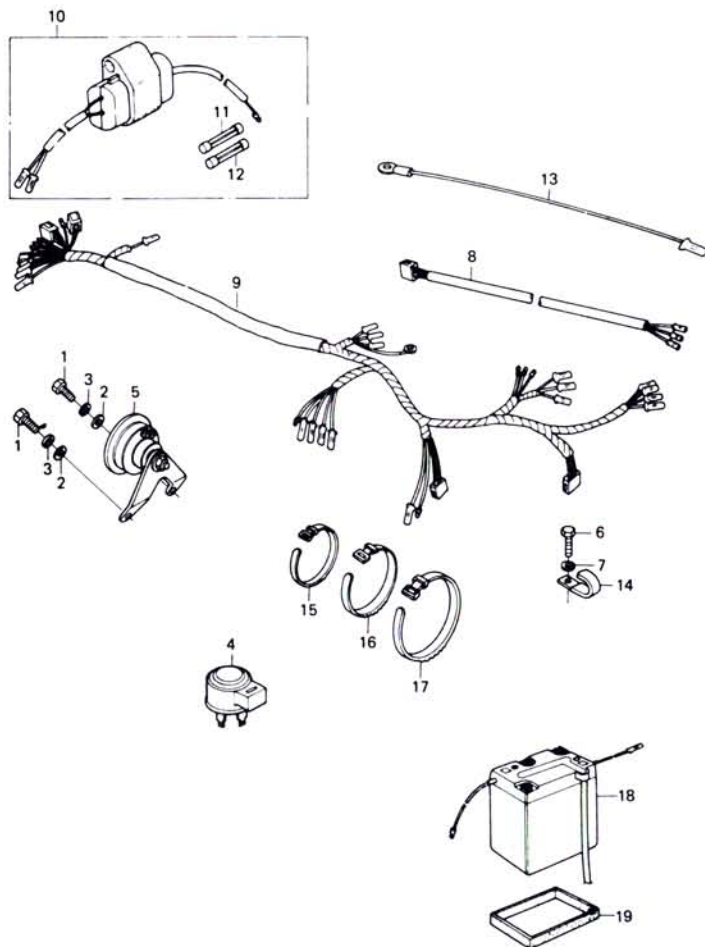

Ref. No.	Part No.	Part Name	Quantity	Remarks
1	110B0616	BOLT, hex head, 6 x 16	2	
2	411B0600	WASHER, plain, 6 m/m	2	
3	461F0600	WASHER, spring, 6 m/m	2	
4	27002-013	RELAY, turn signal	1	
5	27003-1008	HORN	1	
6	110B0612	BOLT, hex head, 6 x 12	1	
7	461F0600	WASHER, spring, 6 m/m	1	
8	26001-1007	WIRING HARNESS, tail light	1	
9	26001-1049	WIRING HARNESS, main	1	
10	26004-1010	FUSE ASSY	1	
11	26006-1002	FUSE, 10A, L = 30 m/m	1	
12	26006-1003	FUSE, 15A, L = 30 m/m	1	
13	26011-093	WIRE, lead, battery ground	1	
14	92037-1069	CLAMP	1	
15	92072-030	BAND, rubber, L = 123 m/m	3	
16	92072-031	BAND, rubber, L = 149 m/m	2	
17	92072-032	BAND, rubber, L = 218 m/m	2	
18	26012-1017	BATTERY, 6V 6AH, 6N6 1C	1	
19	32103-023	NAT, battery	1	

36. Tools

Rev. No.		Date	
----------	--	------	--

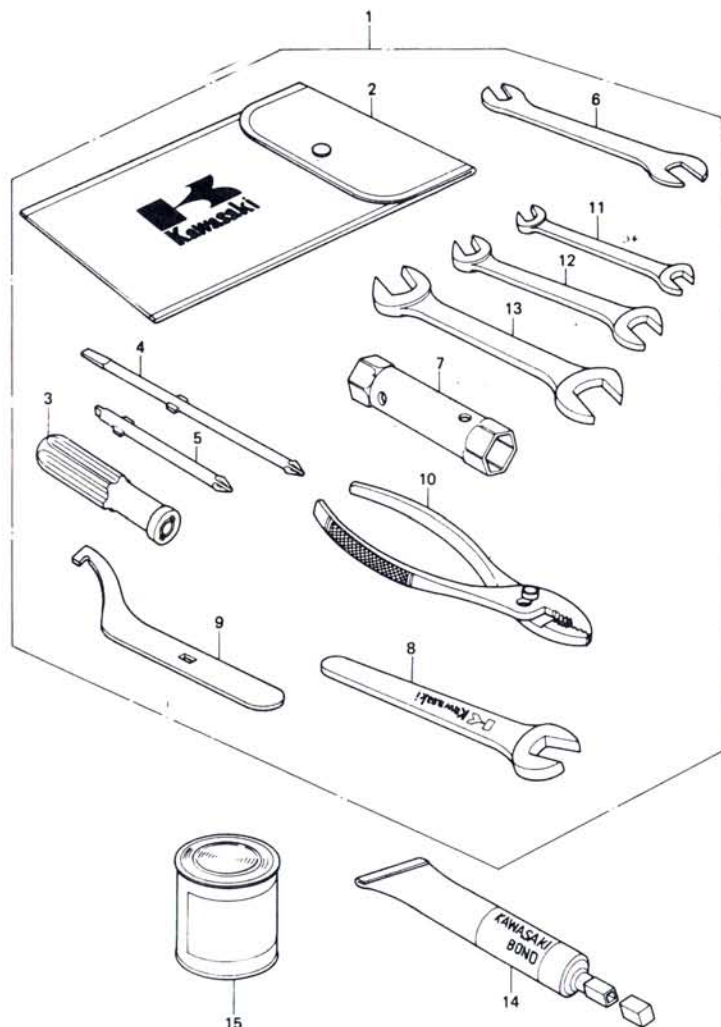

Ref. No.	Part No.	Part Name	Quantity	Remarks
1	56007-1023	TOOL KIT	1	
2	56008-008	BAG, tool	1	
3	92106-1001	GRIP, screwdriver	1	
4	92107-003	SCREWDRIVER, #2 phillips & slot	1	
5	92107-005	SCREWDRIVER, #3 phillips	1	
6	92108-011	WRENCH, spoke	1	
7	92110-012	WRENCH, box, 17 x 21	1	
8	92110-1004	WRENCH, open end, 19 m/m	1	
9	92110-1014	WRENCH, hook	1	
10	92112-005	PLIERS, 125 m/m	1	
11	92126-001	WRENCH, open end, 8 x 10	1	
12	92126-002	WRENCH, open end, 12 x 13	1	
13	92126-003	WRENCH, open end, 14 x 17	1	
14	92104-002	LIQUID GASKET, 100gr tube	(1)	} Option
15	56019-108-B1	PAINT, Firecracker Red, 1/12L	(1)	
	56019-108-C9	PAINT, Brilliant Blue, 1/12L	(1)	
	56019-108-7H	PAINT, Sunflower Yellow, 1/12L	(1)	

Numerical Part Index

* : Indicates the Newly developed parts for Kawasaki Model KE175-D2

Part No.	Page	Q'ty	Part No.	Page	Q'ty	Part No.	Page	Q'ty	Part No.	Page	Q'ty
21119-1003	15	1	23026-1003	35	1	31180500A	33	4	36014-1007	30	1
21121-1012	15	1	23027-1002	35	1	31180500A	37	2	36014-1017	30	1
21130-009	15	1	23035-1003	36	2	31180600	32	1	41080400	13	4
22080308A	12	4	23035-1003	36	2	31180600	33	2	41080500	36	4
22080310A	11	2	23036-1023	35	1	31180600	35	1	41080600	26	1
22080408A	10	1	23037-1039	36	2	31180600	32	1	41080600	22	1
22080410A	12	2	23037-1040	36	2	31180600	35	2	41080600	20	1
22080414A	13	4	23048-1011	36	2	31180600	19	1	41080600	20	1
22080416A	10	4	23048-1011	36	2	31180800	34	2	41080600	19	1
22080508A	12	1	23051-1018	36	2	31180900	14	1	41080600	6	1
22080510A	32	1	23051-1028	36	2	31280500A	37	1	41080600	32	2
22080512A	34	3	23051-1029	36	2	31280300	17	2	41080600	25	1
22080518A	20	2	23058-002	36	4	31581000	36	2	41030600	15	2
22080520A	12	1	23058-002	36	4	31581400	18	2	41080900	37	2
22080522A	20	2	23066-003	36	2	32002-1047	16	1	41080800	22	2
22080535A	14	1	25005-1055	33	1	32002-1142	16	1	41080900	14	1
22080540A	15	4	25008-1019	33	1	32046-1030	31	1	41080800	29	3
22080612	16	1	25010-021	33	1	32046-1031	31	1	41081200	17	1
22080612	7	1	25012-025	33	2	32085-1027	8	1	41002-1083	24	1
22080612	2	2	25015-1049	33	1	32103-023	38	1	41002-1084	24	1
22080612	22	1	25015-1056	33	1	32103-027	16	1	41022-1021	24	1
22080612	19	1	25015-1058	33	1	33001-1023	17	1	41022-1022	24	1
22080614	6	1	25019-013	33	4	33001-1061	17	1	41023-1007	24	1
22080614	7	2	25019-031	3	2	33001-1065	17	1	41023-1008	24	1
22080614	2	1	26001-1007	38	1	33032-1005	17	1	41025-1012	24	1
22080616	30	3	26001-1049	38	1	33040-1010	17	2	41025-1013	24	1
22080616	12	1	26004-1010	38	1	34003-1023	18	1	41027-070	24	18
22080616	8	2	26006-1002	38	1	34003-1024	18	1	41027-5021	24	18
22080616	6	2	26006-1003	38	1	34024-064	18	1	41027-5022	24	9
22080616	6	1	26011-093	38	1	34025-008	18	1	41028-069	24	18
22080620	15	2	26012-1017	38	1	34028-009	17	2	41028-5019	24	9
22080625	9	6	27002-013	38	1	34028-1013	18	1	41034-1014	25	1
22080630	6	1	27003-1008	38	1	34028-1014	18	1	41034-1015	26	1
22080630	9	8	27004-5061	37	1	35004-1024-6K	22	1	41035-1016	25	1
22080635	9	3	27005-1037	37	1	35004-1024-6R	22	1	41035-1017	26	1
22080640	2	8	27008-1024	37	1	35004-1024-6L	22	1	41048-015	25	2
22080640	9	2	27008-1025	37	1	35022-1018-6K	22	1	41048-1012	26	2
22080660	2	4	27008-1026	37	1	35022-1018-6R	22	1	41049-002	26	1
22080440A	35	2	27008-1027	37	1	35022-1018-6L	22	1	41049-002	25	1
22180616	2	4	27010-025	37	1	35022-1017	22	1	41049-011	25	1
23004-1029	34	1	27010-1031	29	1	35034-1029	23	1	41049-011	26	1
23005-1007-6Z	34	1	27016-035	37	1	35034-1050	22	1	41050-1010	25	1
23006-1007	34	1	27021-004	20	1	35037-023	22	1	41050-1011	26	1
23007-1020	34	1	27031-005	37	1	35001-1026-6R	30	1	41051-001	26	1
23008-1043	34	1	27032-001	37	1	36001-1026-6L	30	1	41051-001	25	1
23008-1044	34	1	28012-016	37	2	36001-1026-6K	30	1	41053-1012	25	1
23008-1050	33	1	28012-1001	37	1	36001-1031-6L	30	1	41053-1013	26	1
23021-010	34	3	28012-1005	37	1	36001-1031-6R	30	1	41060-1007	12	1
23025-1006	35	1	2900908	8	1	36001-1031-6K	30	1	41060-1008	12	1

Numerical Part Index

* : Indicates the Newly developed parts for Kawasaki Model KE175-D2

Part No.	Page	Q'ty	Part No.	Page	Q'ty	Part No.	Page	Q'ty	Part No.	Page	Q'ty
11080520A	4	6	11009-1133	36	2	13095-053	4	1	14025-1048	16	1
11080530A	36	4	11009-1178	10	1	13097-1006	4	1	14025-1197	11	1
11080608	21	2	11011-1039	13	1	13100870	1	4	14025-1198	10	1
11080608	14	1	11012-1003	17	1	13106-1002	4	1	14026-1016	9	1
11080612	32	1	11012-1034	13	1	13114-1003	4	1	14030-1009	9	1
11080612	32	1	11012-1036	17	2	13127-1006	5	1	14031-1016	9	1
11080612	22	2	11012-1040	2	1	13128-1008	5	1	14032-1007	9	1
11080612	38	1	11012-1061	21	2	13129-051	5	1	14043-1002	28	1
11080612	17	2	11013-042	13	1	13129-1075	5	1	14069-002	2	1
11080614	31	4	11013-1019	13	1	13129-1134	5	1	14073-1029	13	1
11080614	22	1	11013-1033	13	1	13129-1140	5	1	16001-1155	10	1
11080616	22	1	11034-1117	35	1	13129-1141	5	1	16001-1267	10	1
11080616	38	2	11034-1569	35	1	13129-1142	5	1	16001-1294	10	1
11080616	30	4	113810120	16	2	13129-1143	5	1	16002-014	10	1
11080616	22	2	11381035	17	2	13129-1144	5	1	16003-006	11	1
11080618	32	1	113G1022	19	1	13129-1145	5	1	16004-018	10	1
11080620	35	2	113G1022	4	1	13140-1013	6	2	16006-023	11	1
11080620	19	1	113G1028	19	1	13140-1014	6	1	16008-010	11	1
11080620	7	1	11480816	14	1	13142-008	6	1	16009-1049	11	1
11080620	13	2	114G0825	8	1	13144-066	5	1	16012-019	11	1
11080625	32	1	12021-1005	1	1	13146-002	6	1	16014-1013	11	1
11080625	33	1	13001-1022	3	1	13151-1001	6	1	16016-1011	11	1
11080625	22	4	13001-1041	3	1	13156-1020	7	1	16017-1047	10	1
11080625	1	4	13002-1004	3	1	13157-004	7	1	16017-1051	10	1
11080628	35	1	13008-5021	3	1	13159-1004	11	1	16021-1012	10	1
11080628	35	2	13008-5024	3	1	13161-1006	7	1	16025-1039	11	1
11080640	16	2	13031-1011	3	1	13161-1017	7	1	16030-101f	10	1
11080818	22	2	13033-016	3	1	13168-1023	4	1	16031-1011	10	1
11080828	14	3	13034-042	3	1	13168-1047	7	1	16032-003	10	1
11080860	16	4	13035-022	3	1	13168-1058	7	1	16034-001	10	1
110G0618	4	1	13037-1012	3	1	13169-002	7	1	16038-022	11	1
110G0625	26	1	13037-1013	3	1	13169-1156	16	1	16039-015	11	1
110G0625	25	1	13044-5012	3	1	13169-1157	16	1	16063-004	11	1
110N0625	20	1	13061-1023	8	1	13169-1190	10	1	16065-1025	1	1
110N0625	20	1	13064-1009	8	1	13169-1201	7	1	16082-1012	12	1
110N0832	34	2	13066-1006	8	1	13169-1224	10	1	16115-018	9	1
11001-1017	1	1	13070-1007	8	1	13169-1226	10	2	18001-1043	14	1
11001-1034	1	1	13075-006	8	1	13206-1002	8	1	18006-1027	14	1
11004-1017	1	1	13078-1001	8	1	13209-015	6	2	18006-1050	14	1
11005-1057	1	1	13081-1031	4	1	13236-1004	7	1	13061-060	14	1
11005-1072	1	1	13086-017	4	1	13239-1013	6	1	18063-005	14	3
11009-1013	28	1	13087-041	4	1	13239-1029	6	1	18067-008	14	1
11009-1060	1	1	13088-025	4	5	14002-1023	2	1	18069-049	14	1
11009-1062	9	1	13089-003	4	4	14002-1024	2	1	18070-007	14	1
11009-1063	9	1	13091-1016	6	1	14002-1065	2	1	21003-1023	15	1
11009-1078	35	1	13091-1017	4	1	14002-1079	2	1	21007-1003	6	1
11009-1109	1	1	13091-1018	4	1	14002-1093	2	1	21049-1006	15	1
11009-1128	36	2	13091-1022	22	1	14014-021	2	1	21050-1013	15	1
11009-1128	36	2	13091-1070	6	1	14014-022	2	1	21066-1012	15	1

Numerical Part Index

* : Indicates the Newly developed parts for Kawasaki Model KE175-D2

Part No.	Page	Q'ty	Part No.	Page	Q'ty	Part No.	Page	Q'ty	Part No.	Page	Q'ty
92009-1056	36	4	92022-125	35	2	92036-018	10	1	92055-1016	12	1
92009-1056	36	4	92022-168	4	1	92037-010	29	4	92055-1017	12	1
92011-023	7	1	92022-168	4	1	92037-016	2	1	92055-1060	21	2
92011-026	29	3	92022-169	8	2	92037-061	13	1	92055-1076	10	1
92011-033	14	2	92022-170	5	1	92037-072	11	2	92057-1014	27	1
92011-037	1	1	92022-170	5	1	92037-077	1	1	92057-1036	27	1
92015-019	3	1	92022-172	3	1	92037-1014	32	1	92058-005	27	1
92015-042	19	1	92022-183	28	2	92037-1015	32	1	92059-061	2	1
92015-043	3	1	92022-195	14	1	92037-1016	32	1	92059-1018	11	1
92015-1014	1	4	92022-195	35	2	92037-1033	32	1	92059-107	29	1
92015-1022	26	6	92022-199	17	2	92037-1034	32	1	92059-1090	12	1
92015-1032	26	1	92022-240	30	4	92037-1069	38	1	92059-1116	10	2
92015-1034	25	1	92022-263	33	4	92037-1080	12	1	92059-130	11	1
92015-1055	21	8	92022-269	8	1	92037-1084	32	1	92060-013	12	1
92015-1062	5	1	92022-284	19	1	92037-1163	23	1	92062-1008	12	1
92015-1072	36	2	92022-315	8	2	92037-137	14	2	92063-063	10	1
92015-1073	36	2	92024-031	5	2	92037-157	2	1	92063-070	10	1
92015-1078	33	4	92024-077	3	1	92037-171	14	1	92063-071	10	1
92015-1078	16	2	92026-011	3	2	92038-001	3	1	92063-072	10	1
92017-013	14	2	92026-1018	7	1	92039-1018	23	2	92063-073	10	1
92017-013	16	4	92026-1028	21	2	92042-020	6	5	92063-074	10	1
92019-009	17	1	92026-1054	21	2	92042-042	6	5	92064-032	10	1
92019-014	20	1	92027-1018	23	1	92042-051	3	1	92064-042	10	1
92019-014	20	1	92027-102	14	3	92043-064	19	1	92065-058	2	1
92019-016	19	2	92027-1083	5	1	92043-065	19	1	92066-1014	13	1
92019-021	16	2	92027-1097	25	1	92043-079	17	2	92067-001	2	1
92019-021	18	1	92027-1098	25	1	92043-080	18	2	92069-024	33	3
92020-007	17	2	92027-1099	26	1	92043-1036	31	2	92069-053	34	1
92022-035	14	3	92027-1100	26	1	92043-117	2	1	92069-053	33	3
92022-077	12	4	92027-1101	26	1	92045-018	2	2	92069-056	36	2
92022-077	14	1	92027-1105	34	2	92045-036	6	1	92069-056	36	2
92022-1019	8	1	92027-1181	23	2	92045-1010	4	1	92069-074	35	1
92022-1025	12	1	92027-1181	16	2	92046-026	2	2	92069-1006	34	1
92022-1039	33	4	92027-1182	36	2	92047-010	21	1	92070-015	15	1
92022-104	37	1	92027-1221	15	2	92047-014	16	1	92070-054	15	1
92022-106	5	2	92027-153	13	2	92048-005	16	1	92071-042	2	1
92022-1062	25	1	92027-156	35	1	92048-009	16	1	92071-056	30	6
92022-1071	36	2	92027-156	35	2	92049-1029	21	2	92071-080	30	1
92022-1087	5	1	92027-189	7	1	92050-010	25	1	92071-097	9	1
92022-1088	4	1	92027-194	22	4	92050-039	2	1	92072-030	38	3
92022-1113	5	1	92027-241	33	1	92050-059	25	1	92072-031	38	2
92022-1137	36	2	92027-247	3	1	92050-060	26	1	92072-032	38	2
92022-125	35	4	92027-256	12	1	92051-003	9	1	92075-024	33	2
92022-125	35	1	92028-014	4	1	92051-005	2	1	92075-051	13	2
92022-125	33	3	92028-1027	17	2	92055-044	10	1	92075-099	31	2
92022-125	23	1	92033-1022	21	2	92055-051	29	1	92075-1004	35	1
92022-125	22	2	92033-1023	21	2	92055-087	12	1	92075-1005	35	1
92022-125	22	4	92033-1039	31	2	92055-092	12	1	92075-101	28	2
92022-125	22	2	92036-004	3	2	92055-1015	12	1	92075-103	22	4

Numerical Part Index

* : Indicates the Newly developed parts for Kawasaki Model KE175-D2

Part No.	Page	Q'ty	Part No.	Page	Q'ty
92075-1068	26	1	92106-1001	39	1
92075-1074	28	1	92107-003	39	1
92075-1077	34	2	92107-005	39	1
92075-1078	34	2	92108-011	39	1
92075-1079	36	2	92110-012	39	1
92075-1080	36	2	92110-1004	39	1
92075-1085	13	1	92110-1014	39	1
92075-1094	35	1	92112-005	39	1
92075-1095	35	2	92126-001	39	1
92075-1176	1	12	92126-002	39	1
92075-1176	1	14	92126-003	39	1
92075-121	22	4			
92075-1216	17	2			
92075-1217	17	2			
92075-172	29	3			
92075-209	33	1			
92075-216	31	4			
92075-224	31	1			
92075-284	28	1			
92075-304	1	18			
92075-310	35	2			
92075-310	35	1			
92076-020	17	2			
92077-1007	31	2			
92081-020	8	1			
92081-1071	19	1			
92081-1082	37	1			
92081-1129	7	1			
92081-1133	18	2			
92081-1135	31	2			
92081-1144	34	3			
92081-1152	10	1			
92081-1153	11	1			
92081-1174	4	6			
92081-1181	11	1			
92081-122	8	1			
92081-1237	7	1			
92081-156	7	1			
92082-005	8	1			
92087-1002	25	1			
92090-022	16	1			
92093-1012	14	1			
92093-1013	14	1			
92093-1017	21	2			
92094-011	37	2			
92097-003	37	1			
92101-001	15	1			
92102-009	20	1			
92104-002	39	1			

Part No.	Page	Q'ty	Part No.	Page	Q'ty
----------	------	------	----------	------	------

Numerical Part Index

* : Indicates the Newly developed parts for Kawasaki Model KE175

Part No.	Page	Q'ty	Part No.	Page	Q'ty	Part No.	Page	Q'ty	Part No.	Page	Q'ty
41060-1017	25	1	44045-047	21	2	461F0800	34	2	56002-034	20	1
41060-1018	25	1	44045-051	21	2	461F0900	22	2	56003-009	20	1
41063-001	25	1	45014-1025	17	2	461F0800	17	2	56007-1023	39	1
41064-006	25	1	46003-1022	20	1	461F0800	14	1	56008-008	39	1
41068-1012	25	1	46012-014	20	2	461F0800	14	1	56018-1035	30	2
41068-1013	26	1	46019-1005	20	1	461F0800	20	4	56019-109-B1	39	1
41082-001	25	1	46021-029	20	1	461F0800	14	3	56019-108-C9	39	1
41085-017	26	1	46055-003	20	1	461F1000	17	2	56019-108-7H	39	1
41085-1003	25	1	46055-010	20	1	461F1000	36	2	59026-1008	15	1
41180500	37	2	46056-005	20	1	461F1400	18	2	59031-1003	15	1
41180600	22	3	46056-005	20	1	480J1500	8	1	59051-1010	8	1
41180600	38	2	46058-004	20	1	480J1600	8	3	59051-1019	8	1
41180600	35	1	46060-009-21	20	1	480J2100	5	3	600A0600	16	23
41180600	32	2	46075-1004	20	1	480J2100	5	2	600A0900	16	19
41180600	1	4	46076-044	20	1	481J3500	26	1	600A0900	8	1
41180600	31	4	46091-1041	20	1	481J3700	25	1	601B6004	26	1
41180600	30	3	46091-1075	20	1	481J4200	26	1	601B6202	26	1
41180600	16	1	46092-015	20	1	482K0100	8	1	601B6202U	26	1
41180800	16	4	46094-011-21	20	1	49006-1017	20	1	601B6205	2	1
41180800	34	2	46098-018	16	1	49006-1017	20	1	601B6301	25	2
41180800	17	2	461E0600	15	2	49006-1031	10	1	601B6305	2	1
41181000	16	2	461E1000	4	1	49099-1006	14	1	610A0406	6	1
41108000	34	2	461E1400	3	1	510A4200	3	1	653B254007	2	1
42033-1007	26	1	461F0300	12	4	510J1-1013-C9	28	1	653B324507	2	1
42036-1019	17	1	461F0300	11	2	510J1-1013-7H	28	1	670B1509	4	1
42036-1020	26	1	461F0400	11	4	510J1-5052	28	1	670B1509	11	1
42041-1020	27	1	461F0400	12	2	51023-1020	28	1	670B2010	28	1
42041-1030	27	1	461F0500	37	1	51039-003	28	1	670B2012	8	2
42041-1040	27	1	461F0500	36	4	51048-1004	28	1	670B2016	19	2
42041-1046	27	1	461F0500	34	3	51059-006	28	1	670H2020	3	1
42041-1047	27	1	461F0500	32	1	520J1-1006	29	1	700Q05470	29	1
42041-1050	27	1	461F0500	15	4	52003-023	29	1	702A05300	28	1
43001-1020	19	1	461F0600	31	4	52005-1005	9	1	92001-1003	7	1
43007-048	19	1	461F0600	38	1	52015-002	29	1	92001-1091	28	2
43011-1009	19	1	461F0600	33	1	53001-1022	31	1	92001-1118	35	2
43012-001	19	1	461F0600	32	3	53001-1057	31	1	92001-1136	21	8
44001-1045	21	1	461F0600	30	3	540J1-1011	32	1	92001-1179	17	2
44005-1017	21	1	461F0600	30	4	54005-1014	32	1	92001-1210	21	1
44006-1017	21	1	461F0600	19	1	54011-1014	32	1	92003-130	4	1
44010-027	21	1	461F0600	38	2	54012-1052	32	1	92003-157	18	1
44013-1014	21	2	461F0600	35	2	54018-1007	32	1	92003-204	33	4
44022-1015	21	2	461F0600	17	2	550D2015	17	2	92004-1008	1	2
44026-1019	21	2	461F0600	22	6	550D2015	19	1	92004-1009	1	4
44026-1034	21	2	461F0600	22	4	550D2516	18	2	92004-1015	26	6
44028-1005	21	2	461F0600	16	1	55020-1025	30	1	92007-002	20	4
44029-1012	21	2	461F0600	35	2	55020-1026	17	1	92007-027	37	2
44037-1012	21	1	461F0600	13	2	551A0R16	2	2	92007-046	20	1
44039-1020	21	1	461F0600	1	4	552B1012	2	2	92007-046	20	1
44041-078	21	2	461F0600	35	1	56002-020	20	1	92008-007	37	1